

**POLY
CONN**

Master **WAIRhouse**[®]
Fluid Power Products



Tubing and Hose Accessories



Features and Specifications for T-Clips

T-Clips provide a quick, adaptable and inexpensive answer to securing, attaching tubes, routing tubes, wires, hose and pipe. They allow installations to look extremely neat and professional. They are easy to install. T-Clips provide an exact, uniform spacing to dual runs and can be mounted on walls, cabinets, board enclosures and bulkheads. As many spacers as necessary may be stacked to provide the required height or clearance.

SPECIFICATIONS

Product	Spacer Temperature	T-Clip Temp.	Spacer Material
T-Clips	-40°F to +212°F	230°F	Polyacetal Engineered Plastic with Ultraviolet Inhibitors

FEATURES

- * Center mounting hole for convenience
- * Precision injection molded acetal plastic
- * Provide quick, secure mounting with exact spacing between tubes

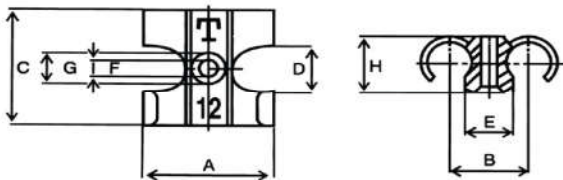

USES

- * Many commercial applications such as installation of hydraulic or automotive hoses, electrical conduct, telephone wires, fiber optic cables and liquid/gas tubes/piping may benefit from the ease of installation, safety and appearance of job
- * Some industries where T-Clips are used include:
 - Marine
 - Machine Tools
 - Plumbing
 - Air Conditioning
 - Pneumatics
 - Refrigeration
 - Appliances
 - Construction
 - Electrical
 - Heating
 - Robotics
 - Hydraulics
 - Automotive
 - Medical Equipment
 - Recreational Vehicles

Part Number	Tube OD	A	B	C	D	E	F	G	H	List Price	QTY	Pkg Price
PCT-4-2	5/32"	0.61	0.40	0.70	0.24	0.27	0.12	0.22	0.37	\$ 0.45	50	\$ 22.52
PCT-6-2	1/4"	0.811	0.506	0.808	0.324	0.334	0.122	0.262	0.364	\$ 0.55	50	\$ 27.34
PCT-8-2	5/16"	1.00	0.626	0.970	0.404	0.414	0.162	0.322	0.484	\$ 0.58	50	\$ 28.95
PCT-10-2	3/8"	1.21	0.74	1.09	0.46	0.43	0.16	0.32	0.56	\$ 0.59	50	\$ 29.53
PCT-12-2	1/2"	1.37	0.82	1.32	0.56	0.46	0.17	0.34	0.64	\$ 0.68	50	\$ 33.77
PCT-15-2	5/8"	1.70	1.03	1.60	0.66	0.55	0.20	0.40	0.78	\$ 0.96	50	\$ 48.25
PCT-18-2	3/4"	2.02	1.22	1.85	0.77	0.62	0.22	0.44	0.90	\$ 1.14	25	\$ 28.44
PCT-22-2	7/8"	2.45	1.50	2.36	0.88	0.78	0.25	0.49	1.08	\$ 1.56	25	\$ 38.96

Features and Specifications for Tube Racks

Tube racks will keep your pneumatic hoses and tubes neat and in order. These sturdy plastic racks have 5, 7, or 10 tubing channels (depending on diameter) to clip hoses and tubes in place. The channels can easily be hand separated down to single holders. Tube racks from Polyconn will help avoid tangles and kinks in your pneumatic hoses, and will keep your multiple lines from turning into a jumbled mess.

FEATURES

- * Adhesive fastener available on 5/32, 3/16 and 1/4
- * Thru holes provided on all sizes
- * Made from high density polyethylene

USES

- * Route and secure multiple tubing lines
- * Channels can easily be hand separated down to single holders

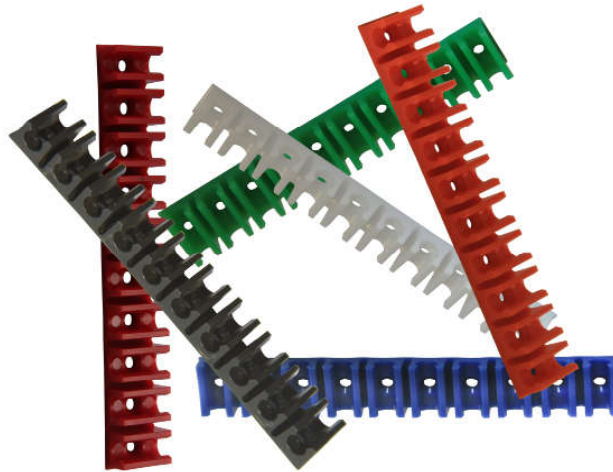

Part Number	Tube OD	Mounting Hole Dia	Features	Color	Channels	List Price	QTY	Pkg Price
PCTR156-102	5/32"	0.115"	Non-Adhesive Back	Black	10	\$ 0.95	10	\$ 9.53
PCTR156-103	5/32"	0.115"	Non-Adhesive Back	Red	10	\$ 0.95	10	\$ 9.53
PCTR156-112	5/32"	0.115"	Adhesive Back	Black	10	\$ 1.08	10	\$ 10.76
PCTR187-102	3/16"	0.115"	Non-Adhesive Back	Black	10	\$ 0.93	10	\$ 9.30
PCTR187-103	3/16"	0.115"	Non-Adhesive Back	Red	10	\$ 0.99	10	\$ 9.89
PCTR187-112	3/16"	0.115"	Adhesive Back	Black	10	\$ 1.11	10	\$ 11.11
PCTR187-113	3/16"	0.115"	Adhesive Back	Red	10	\$ 1.11	10	\$ 11.11
PCTR250-102	1/4"	0.115"	Non-Adhesive Back	Black	10	\$ 0.93	10	\$ 9.30
PCTR250-103	1/4"	0.115"	Non-Adhesive Back	Red	10	\$ 0.93	10	\$ 9.30
PCTR250-104	1/4"	0.115"	Non-Adhesive Back	Blue	10	\$ 0.93	10	\$ 9.30
PCTR250-105	1/4"	0.115"	Non-Adhesive Back	Green	10	\$ 0.93	10	\$ 9.30
PCTR250-106	1/4"	0.115"	Non-Adhesive Back	Yellow	10	\$ 0.93	10	\$ 9.30
PCTR250-107	1/4"	0.115"	Non-Adhesive Back	Orange	10	\$ 0.93	10	\$ 9.30
PCTR250-108	1/4"	0.115"	Non-Adhesive Back	Gray	10	\$ 0.93	10	\$ 9.30
PCTR250-109	1/4"	0.115"	Non-Adhesive Back	White	10	\$ 0.93	10	\$ 9.30
PCTR250-112	1/4"	0.115"	Adhesive Back	Black	10	\$ 1.08	10	\$ 10.76
PCTR250-113	1/4"	0.115"	Adhesive Back	Red	10	\$ 1.08	10	\$ 10.76
PCTR250-114	1/4"	0.115"	Adhesive Back	Blue	10	\$ 1.08	10	\$ 10.76
PCTR250-115	1/4"	0.115"	Adhesive Back	Green	10	\$ 1.08	10	\$ 10.76
PCTR250-116	1/4"	0.115"	Adhesive Back	Yellow	10	\$ 1.08	10	\$ 10.76
PCTR250-117	1/4"	0.115"	Adhesive Back	Orange	10	\$ 1.08	10	\$ 10.76
PCTR250-118	1/4"	0.115"	Adhesive Back	Gray	10	\$ 1.08	10	\$ 10.76
PCTR250-119	1/4"	0.115"	Adhesive Back	White	10	\$ 1.08	10	\$ 10.76
PCTR250-2	1/4"	N/A	Non-Separable	Black	10	\$ 2.54	10	\$ 25.42
PCTR375-2	3/8"	0.20"	Non-Separable	Black	7	\$ 6.10	10	\$ 61.01
PCTR500-2	1/2"	0.20"	Non-Separable	Black	5	\$ 292	10	\$ 29.17

Features and Specifications for Tube Markers

Our tube markers are a quick and easy way to keep track of which tube is which in your system or facility. These small, cylindrical, white plastic markers snap on and off easily, and their coded black lettering is easy to read, even at a distance. Polyconn tube markers won't pinch, kink, or mar tubing. Numbers 0-9 and select capital letters are available, as well as markers with acronyms/abbreviations (CYL=cylinder, for example). We also sell kits with an assortment of alphanumeric or abbreviated markers included.

FEATURES

- * Will not pinch, kink, or mar tubing
- * Hot stamped and imprinted black coding on white background
- * Kits available

ORDERING INFORMATION

- * Tube markers are sold in package quantities of 50

NUMERICAL TUBE MARKERS



Part #	Tube OD	Imprint	List Price	QTY	Pkg Price
TM1-0	5/32"	0	\$ 0.15	50	\$ 7.55
TM1-1	5/32"	1	\$ 0.15	50	\$ 7.55
TM1-2	5/32"	2	\$ 0.15	50	\$ 7.55
TM1-3	5/32"	3	\$ 0.15	50	\$ 7.55
TM1-4	5/32"	4	\$ 0.15	50	\$ 7.55
TM1-5	5/32"	5	\$ 0.15	50	\$ 7.55
TM1-6	5/32"	6	\$ 0.15	50	\$ 7.55
TM1-7	5/32"	7	\$ 0.15	50	\$ 7.55
TM1-8	5/32"	8	\$ 0.15	50	\$ 7.55
TM1-9	5/32"	9	\$ 0.15	50	\$ 7.55

Part #	Tube OD	Imprint	List Price	QTY	Pkg Price
TM2-0	1/8"	0	\$ 0.14	50	\$ 6.90
TM2-1	1/8"	1	\$ 0.14	50	\$ 6.90
TM2-2	1/8"	2	\$ 0.14	50	\$ 6.90
TM2-3	1/8"	3	\$ 0.14	50	\$ 6.90
TM2-4	1/8"	4	\$ 0.14	50	\$ 6.90
TM2-5	1/8"	5	\$ 0.14	50	\$ 6.90
TM2-6	1/8"	6	\$ 0.14	50	\$ 6.90
TM2-7	1/8"	7	\$ 0.14	50	\$ 6.90
TM2-8	1/8"	8	\$ 0.14	50	\$ 6.90
TM2-9	1/8"	9	\$ 0.14	50	\$ 6.90

Part #	Tube OD	Imprint	List Price	QTY	Pkg Price
TM4-0	1/4"	0	\$ 0.19	50	\$ 9.65
TM4-1	1/4"	1	\$ 0.19	50	\$ 9.65
TM4-2	1/4"	2	\$ 0.19	50	\$ 9.65
TM4-3	1/4"	3	\$ 0.19	50	\$ 9.65
TM4-4	1/4"	4	\$ 0.19	50	\$ 9.65
TM4-5	1/4"	5	\$ 0.19	50	\$ 9.65
TM4-6	1/4"	6	\$ 0.19	50	\$ 9.65
TM4-7	1/4"	7	\$ 0.19	50	\$ 9.65
TM4-8	1/4"	8	\$ 0.19	50	\$ 9.65
TM4-9	1/4"	9	\$ 0.19	50	\$ 9.65

Part #	Tube OD	Imprint	List Price	QTY	Pkg Price
TM6-0	3/8"	0	\$ 0.39	50	\$ 19.27
TM6-1	3/8"	1	\$ 0.39	50	\$ 19.27
TM6-2	3/8"	2	\$ 0.39	50	\$ 19.27
TM6-3	3/8"	3	\$ 0.39	50	\$ 19.27
TM6-4	3/8"	4	\$ 0.39	50	\$ 19.27
TM6-5	3/8"	5	\$ 0.39	50	\$ 19.27
TM6-6	3/8"	6	\$ 0.39	50	\$ 19.27
TM6-7	3/8"	7	\$ 0.39	50	\$ 19.27
TM6-8	3/8"	8	\$ 0.39	50	\$ 19.27
TM6-9	3/8"	9	\$ 0.39	50	\$ 19.27

ALPHA TUBE MARKERS



Part #	Tube OD	Imprint	List Price	QTY	Pkg Price
TM1-A	5/32"	A	\$ 0.15	50	\$ 7.55
TM1-B	5/32"	B	\$ 0.15	50	\$ 7.55
TM1-C	5/32"	C	\$ 0.15	50	\$ 7.55
TM1-D	5/32"	D	\$ 0.15	50	\$ 7.55
TM1-E	5/32"	E	\$ 0.15	50	\$ 7.55
TM1-F	5/32"	F	\$ 0.15	50	\$ 7.55
TM1-G	5/32"	G	\$ 0.15	50	\$ 7.55
TM1-H	5/32"	H	\$ 0.15	50	\$ 7.55
TM1-J	5/32"	J	\$ 0.15	50	\$ 7.55
TM1-L	5/32"	L	\$ 0.15	50	\$ 7.55
TM1-P	5/32"	P	\$ 0.15	50	\$ 7.55
TM1-R	5/32"	R	\$ 0.15	50	\$ 7.55
TM1-S	5/32"	S	\$ 0.15	50	\$ 7.55
TM1-T	5/32"	T	\$ 0.15	50	\$ 7.55
TM1-X	5/32"	X	\$ 0.15	50	\$ 7.55
TM1-Y	5/32"	Y	\$ 0.15	50	\$ 7.55
TM1-Z	5/32"	Z	\$ 0.15	50	\$ 7.55

Part #	Tube OD	Imprint	List Price	QTY	Pkg Price
TM2-A	1/8"	A	\$ 0.14	50	\$ 6.90
TM2-B	1/8"	B	\$ 0.14	50	\$ 6.90
TM2-C	1/8"	C	\$ 0.14	50	\$ 6.90
TM2-D	1/8"	D	\$ 0.14	50	\$ 6.90
TM2-E	1/8"	E	\$ 0.14	50	\$ 6.90
TM2-F	1/8"	F	\$ 0.14	50	\$ 6.90
TM2-G	1/8"	G	\$ 0.14	50	\$ 6.90
TM2-H	1/8"	H	\$ 0.14	50	\$ 6.90
TM2-J	1/8"	J	\$ 0.14	50	\$ 6.90
TM2-L	1/8"	L	\$ 0.14	50	\$ 6.90
TM2-M	1/8"	M	\$ 0.14	50	\$ 6.90
TM2-N	1/8"	N	\$ 0.14	50	\$ 6.90
TM2-P	1/8"	P	\$ 0.14	50	\$ 6.90
TM2-R	1/8"	R	\$ 0.14	50	\$ 6.90
TM2-S	1/8"	S	\$ 0.14	50	\$ 6.90
TM2-T	1/8"	T	\$ 0.14	50	\$ 6.90
TM2-V	1/8"	V	\$ 0.14	50	\$ 6.90
TM2-X	1/8"	X	\$ 0.14	50	\$ 6.90
TM2-Y	1/8"	Y	\$ 0.14	50	\$ 6.90
TM2-Z	1/8"	Z	\$ 0.14	50	\$ 6.90

Part #	Tube OD	Imprint	List Price	QTY	Pkg Price
TM4-A	1/4"	A	\$ 0.19	50	\$ 9.65
TM4-B	1/4"	B	\$ 0.19	50	\$ 9.65
TM4-C	1/4"	C	\$ 0.19	50	\$ 9.65
TM4-D	1/4"	D	\$ 0.19	50	\$ 9.65
TM4-E	1/4"	E	\$ 0.19	50	\$ 9.65
TM4-F	1/4"	F	\$ 0.19	50	\$ 9.65
TM4-G	1/4"	G	\$ 0.19	50	\$ 9.65
TM4-H	1/4"	H	\$ 0.19	50	\$ 9.65
TM4-I	1/4"	I	\$ 0.19	50	\$ 9.65
TM4-J	1/4"	J	\$ 0.19	50	\$ 9.65
TM4-K	1/4"	K	\$ 0.19	50	\$ 9.65
TM4-L	1/4"	L	\$ 0.19	50	\$ 9.65
TM4-M	1/4"	M	\$ 0.19	50	\$ 9.65
TM4-N	1/4"	N	\$ 0.19	50	\$ 9.65
TM4-O	1/4"	O	\$ 0.19	50	\$ 9.65
TM4-P	1/4"	P	\$ 0.19	50	\$ 9.65
TM4-Q	1/4"	Q	\$ 0.19	50	\$ 9.65
TM4-R	1/4"	R	\$ 0.19	50	\$ 9.65
TM4-S	1/4"	S	\$ 0.19	50	\$ 9.65
TM4-T	1/4"	T	\$ 0.19	50	\$ 9.65
TM4-U	1/4"	U	\$ 0.19	50	\$ 9.65
TM4-V	1/4"	V	\$ 0.19	50	\$ 9.65
TM4-W	1/4"	W	\$ 0.19	50	\$ 9.65
TM4-X	1/4"	X	\$ 0.19	50	\$ 9.65
TM4-Y	1/4"	Y	\$ 0.19	50	\$ 9.65
TM4-Z	1/4"	Z	\$ 0.19	50	\$ 9.65

Part #	Tube OD	Imprint	List Price	QTY	Pkg Price
TM6-A	3/8"	A	\$ 0.39	50	\$ 19.27
TM6-B	3/8"	B	\$ 0.39	50	\$ 19.27
TM6-C	3/8"	C	\$ 0.39	50	\$ 19.27
TM6-D	3/8"	D	\$ 0.39	50	\$ 19.27
TM6-E	3/8"	E	\$ 0.39	50	\$ 19.27
TM6-F	3/8"	F	\$ 0.39	50	\$ 19.27
TM6-G	3/8"	G	\$ 0.39	50	\$ 19.27
TM6-H	3/8"	H	\$ 0.39	50	\$ 19.27
TM6-J	3/8"	J	\$ 0.39	50	\$ 19.27
TM6-P	3/8"	P	\$ 0.39	50	\$ 19.27
TM6-R	3/8"	R	\$ 0.39	50	\$ 19.27
TM6-X	3/8"	X	\$ 0.39	50	\$ 19.27
TM6-Y	3/8"	Y	\$ 0.39	50	\$ 19.27
TM6-Z	3/8"	Z	\$ 0.39	50	\$ 19.27

LEGEND/CODE TUBE MARKER



Part #	Tube OD	Imprint	List Price	QTY	Pkg Price
TM1- -	5/32"	- (retract)	\$ 0.15	50	\$ 7.55
TM1-+	5/32"	+ (extend)	\$ 0.15	50	\$ 7.55
TM1-CYL	5/32"	CYL (cylinder)	\$ 0.26	50	\$ 13.22
TM1-IN	5/32"	IN (input)	\$ 0.23	50	\$ 11.32
TM1-LV	5/32"	LV (limit valve)	\$ 0.23	50	\$ 11.32
TM1-OUT	5/32"	OUT (output)	\$ 0.26	50	\$ 13.22
TM1-PV	5/32"	PV (power valve)	\$ 0.23	50	\$ 11.32

Part #	Tube OD	Imprint	List Price	QTY	Pkg Price
TM2- -	1/8"	- (retract)	\$ 0.14	50	\$ 6.90
TM2-+	1/8"	+ (extend)	\$ 0.14	50	\$ 6.90
TM2-CYL	1/8"	CYL (cylinder)	\$ 0.24	50	\$ 12.08
TM2-IN	1/8"	IN (input)	\$ 0.21	50	\$ 10.35
TM2-LV	1/8"	LV (limit valve)	\$ 0.21	50	\$ 10.35
TM2-OUT	1/8"	OUT (output)	\$ 0.24	50	\$ 12.08
TM2-PV	1/8"	PV (power valve)	\$ 0.21	50	\$ 10.35

Part #	Tube OD	Imprint	List Price	QTY	Pkg Price
TM4- -	1/4"	- (retract)	\$ 0.19	50	\$ 9.65
TM4-+	1/4"	+ (extend)	\$ 0.19	50	\$ 9.65
TM4-CYL	1/4"	CYL (cylinder)	\$ 0.34	50	\$ 16.90
TM4-IN	1/4"	IN (input)	\$ 0.29	50	\$ 14.48
TM4-LV	1/4"	LV (limit valve)	\$ 0.29	50	\$ 14.48
TM4-OUT	1/4"	OUT (output)	\$ 0.34	50	\$ 16.90
TM4-PV	1/4"	PV (power valve)	\$ 0.29	50	\$ 14.48

Part #	Tube OD	Imprint	List Price	QTY	Pkg Price
TM6- -	3/8"	- (retract)	\$ 0.39	50	\$ 19.27
TM6-+	3/8"	+ (extend)	\$ 0.39	50	\$ 19.27
TM6-CYL	3/8"	CYL (cylinder)	\$ 0.67	50	\$ 33.72
TM6-IN	3/8"	IN (input)	\$ 0.58	50	\$ 28.92
TM6-LV	3/8"	LV (limit valve)	\$ 0.58	50	\$ 28.92
TM6-OUT	3/8"	OUT (output)	\$ 0.67	50	\$ 33.72
TM6-PV	3/8"	PV (power valve)	\$ 0.58	50	\$ 28.92

TUBE MARKER KITS



KIT 2 - ALPHA/NUMERIC

Part #	Tube OD	QTY	List Price
TM1-KIT2	5/32"	1	\$ 193.50
TM2-KIT2	1/8"	1	\$ 196.67
TM4-KIT2	1/4"	1	\$ 330.00
TM6-KIT2	3/8"	1	\$ 439.33

* Kit 2 contains 50 of each Alpha/Numeric markers listed below

Imprint	QTY	Imprint	QTY
0	50	A	50
1	50	B	50
2	50	C	50
3	50	D	50
4	50	E	50
5	50	F	50
6	50	G	50
7	50	H	50
8	50	J	50
9	50	P	50
		R	50
		X	50
		Y	50
		Z	50

KIT 3 - LEGEND/CODE

Part #	Tube OD	QTY	List Price
TM1-KIT3	5/32"	1	\$ 71.69
TM2-KIT3	1/8"	1	\$ 65.56
TM4-KIT3	1/4"	1	\$ 91.69
TM6-KIT3	3/8"	1	\$ 183.08

* Kit 3 contains 50 of each Legend/Code markers listed below

Imprint	QTY
CYL (cylinder)	50
PV (power valve)	50
LV (limit valve)	50
IN (input)	50
OUT (output)	50
+ (extend)	50
- (retract)	50

TUBE CUTTER AND BLADES



Part #	Description	QTY	List Price
PCTC-1000	TUBE CUTTER	1	\$ 12.32
PCRB-1000	REPLACEMENT BLADES	1	\$ 20.14

Now that you have your
Fittings don't forget
your tubing!



Polyconn offers Push-In
fittings in many different
materials!



Polyconn carries Polyurethane,
Nylon, Polyethylene and many
more materials to choose from!

Available Materials:
Composite
Plastic
Nickel Plated Brass
Stainless Steel
D.O.T. Brass

Polyconn[®] the one-stop shop for your
pneumatic needs.