

# POLY CONN<sup>®</sup>

Master *WAIR*house<sup>®</sup>  
Fluid Power Products

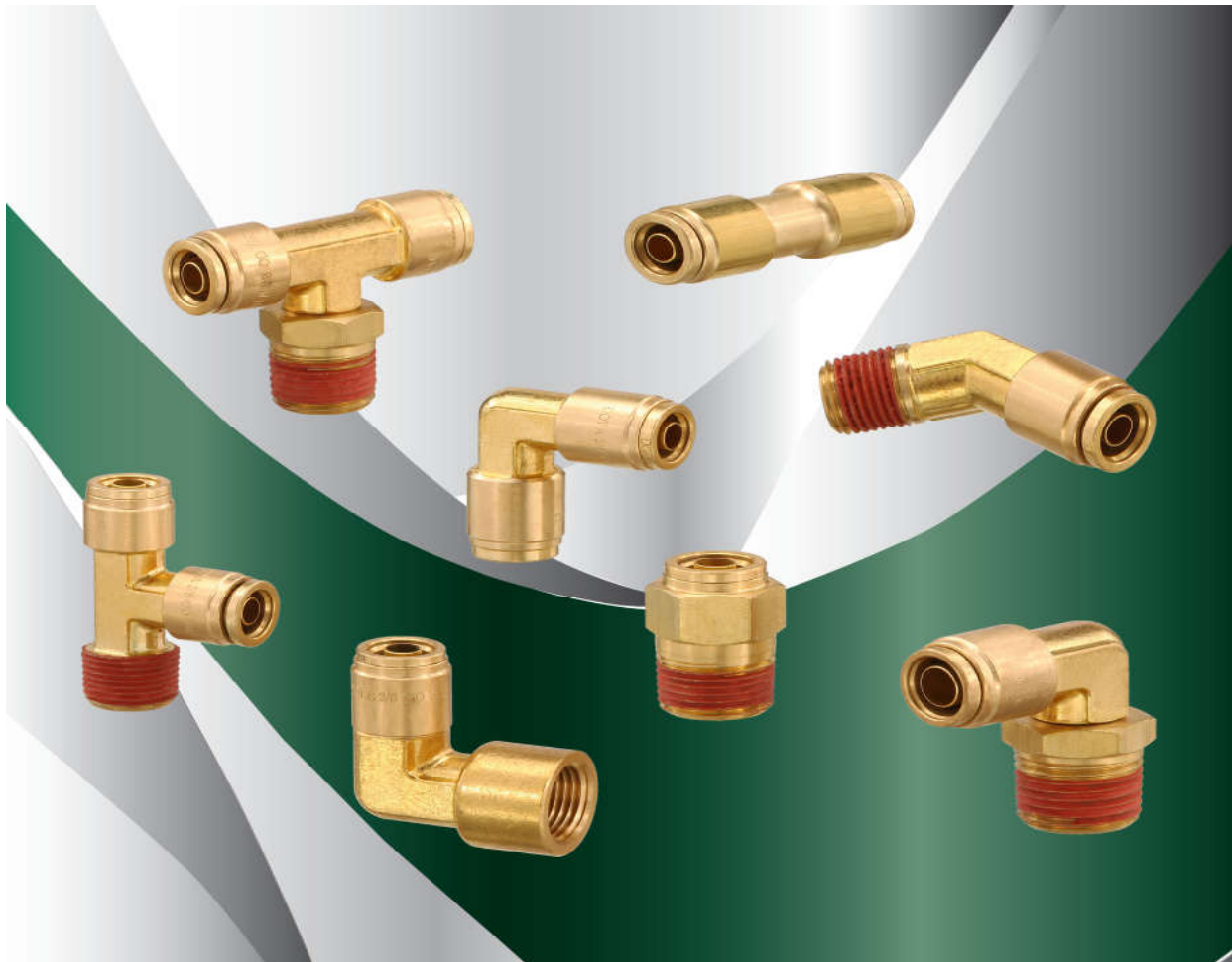

# D.O.T. Brass Fittings



Version 2020  
Revised 01/2020  
Email your order to: [sales@polyconn.com](mailto:sales@polyconn.com) or fax to (763) 398-2590 · [www.polyconn.com](http://www.polyconn.com) · Questions call: (763)559-0388  
3062 Ranchview Lane North · Plymouth, MN 55447

# Features and Specifications for D.O.T Fittings.

## FEATURES

- \* Simply push in tubing for quick connection - no tools or loose parts to handle in tight places.
- \* Brass construction.
- \* Elbows and tees are forged brass.
- \* Pre-applied sealant on all male pipe threads.
- \* Viton O-ring sealing in all of fittings.
- \* These fittings meet D.O.T. FMVSS 571.106 Air Brake Performance Requirements; SAE J1131, J2494-1 & J2494-3 Air Brake Performance Requirements.

## USES

- \* Windows
- \* Door locks
- \* Mirrors
- \* Wipers
- \* Air Operated Seats
- \* Operating gauges
- \* Air horns
- \* Heater controls
- \* Gear shifts
- \* Fifth Wheels
- \* Air Brake Connections

## SPECIFICATIONS

Product	Temperature Range	Pressure Range	Material
Brass D.O.T Push-In Fittings	-30°F - 250°F (0°C - 60°C)	0 - 250 PSI	Brass

## 45° MALE ELBOW



Part #	Push-In	NPT M	List Price	QTY	Pkg Price
PC54-DOT-42	1/4"	1/8"	\$ 6.87	5	\$ 34.36
PC54-DOT-44	1/4"	1/4"	\$ 8.08	5	\$ 40.38
PC54-DOT-46	1/4"	3/8"	\$ 8.81	5	\$ 44.03
PC54-DOT-62	3/8"	1/8"	\$ 8.20	5	\$ 41.02
PC54-DOT-64	3/8"	1/4"	\$ 8.20	5	\$ 41.02
PC54-DOT-66	3/8"	3/8"	\$ 8.81	5	\$ 44.03
PC54-DOT-68	3/8"	1/2"	\$ 12.16	5	\$ 60.78
PC54-DOT-84	1/2"	1/4"	\$ 12.16	5	\$ 60.78
PC54-DOT-86	1/2"	3/8"	\$ 13.19	5	\$ 65.94
PC54-DOT-88	1/2"	1/2"	\$ 13.62	5	\$ 68.08
PC54-DOT-106	5/8"	3/8"	\$ 19.07	5	\$ 95.36
PC54-DOT-108	5/8"	1/2"	\$ 19.80	5	\$ 99.01
PC54-DOT-128	3/4"	1/2"	\$ 26.37	5	\$ 131.87
PC54-DOT-1212	3/4"	3/4"	\$ 30.80	5	\$ 154.00

## 45° MALE ELBOW SWIVEL



Part #	Push-In	NPT M	List Price	QTY	Pkg Price
PC54-DOTS-42	1/4"	1/8"	\$ 6.79	5	\$ 33.93
PC54-DOTS-44	1/4"	1/4"	\$ 8.03	5	\$ 40.16
PC54-DOTS-62	3/8"	1/8"	\$ 7.82	5	\$ 39.09
PC54-DOTS-64	3/8"	1/4"	\$ 8.29	5	\$ 41.45
PC54-DOTS-66	3/8"	3/8"	\$ 9.19	5	\$ 45.96
PC54-DOTS-68	3/8"	1/2"	\$ 12.97	5	\$ 64.86
PC54-DOTS-84	1/2"	1/4"	\$ 12.71	5	\$ 63.57
PC54-DOTS-86	1/2"	3/8"	\$ 13.57	5	\$ 67.87
PC54-DOTS-88	1/2"	1/2"	\$ 16.54	5	\$ 82.69
PC54-DOTS-104	5/8"	1/4"	\$ 21.99	5	\$ 109.97
PC54-DOTS-108	5/8"	1/2"	\$ 18.94	5	\$ 94.72
PC54-DOTS-128	3/4"	1/2"	\$ 32.26	5	\$ 161.30
PC54-DOTS-1212	3/4"	3/4"	\$ 21.01	5	\$ 105.03

## UNION TEE

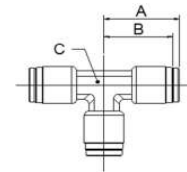

Part #	PI-A	PI-B	A	B	C	List Price	QTY	Pkg Price
PC64-DOT-1	5/32"	5/32"				\$ 9.02	5	\$ 45.10
PC64-DOT-4	1/4"	1/4"	23.2	21.2	9.2	\$ 9.88	5	\$ 49.40
PC64-DOT-6	3/8"	3/8"	25.3	23.3	12.5	\$ 11.86	5	\$ 59.28
PC64-DOT-8	1/2"	1/2"	30.8	28.8	15.5	\$ 13.10	5	\$ 65.51
PC64-DOT-10	5/8"	5/8"	34.2	32.2	20.5	\$ 24.06	5	\$ 120.28
PC64-DOTR-64	3/8"	1/4"				\$ 14.65	5	\$ 73.24

Measurements are in mm unless otherwise noted

## UNION ELBOW

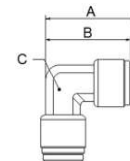

Part #	Push-In	A	B	C	List Price	QTY	Pkg Price
PC65-DOT-4	1/4"	27.9	25.9	9.2	\$ 6.44	5	\$ 32.22
PC65-DOT-6	3/8"	31.5	29.5	12.5	\$ 8.59	5	\$ 42.96
PC65-DOT-8	1/2"	38.6	36.6	15.5	\$ 12.46	5	\$ 62.29

Measurements are in mm unless otherwise noted

## FEMALE CONNECTOR

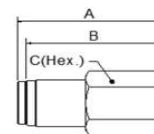

Part #	PI	NPT F	A	B	C	List Price	QTY	Pkg Price
PC66-DOT-42	1/4"	1/8"	32	30	9/16"	\$ 3.74	5	\$ 18.69
PC66-DOT-44	1/4"	1/4"	35	33	19	\$ 5.07	5	\$ 25.34
PC66-DOT-64	3/8"	1/4"	39	37	19	\$ 5.46	5	\$ 27.28
PC66-DOT-66	3/8"	3/8"	40	38	7/8"	\$ 6.79	5	\$ 33.93
PC66-DOT-68	3/8"	1/2"	42	40	1-1/8"	\$ 12.46	5	\$ 62.29
PC66-DOT-84	1/2"	1/4"	38	36	7/8"	\$ 9.54	5	\$ 47.68
PC66-DOT-86	1/2"	3/8"	38.3	36.3	7/8"	\$ 7.90	5	\$ 39.52
PC66-DOT-88	1/2"	1/2"	42.8	40.8	1-1/8"	\$ 8.46	5	\$ 42.31

Measurements are in mm unless otherwise noted

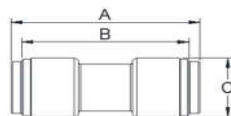

Part #	Push-In	A	B	C	List Price	QTY	Pkg Price
PC62-DOT-1	5/32"				\$ 3.87	5	\$ 19.33
PC62-DOT-4	1/4"	40.9	36.9	12	\$ 4.08	5	\$ 20.40
PC62-DOT-6	3/8"	42.8	38.8	5/8"	\$ 4.85	5	\$ 24.27
PC62-DOT-8	1/2"	46.6	42.6	20	\$ 8.55	5	\$ 42.74
PC62-DOT-10	5/8"	43.6	43.6	25	\$ 17.78	5	\$ 88.92
PC62-DOT-12	3/4"	53	49	27.5	\$ 17.83	5	\$ 89.13

Measurements are in mm unless otherwise noted

## MALE CONNECTOR

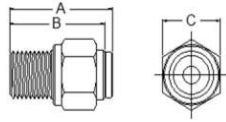

Part #	PI	NPT M	A	B	C	List Price	QTY	Pkg Price
PC68-DOT-41	1/4"	5/32"				\$ 2.92	5	\$ 14.61
PC68-DOT-42	1/4"	1/8"	24.9	22.9	1/2"	\$ 2.62	5	\$ 13.10
PC68-DOT-44	1/4"	1/4"	26.7	24.7	9/16"	\$ 3.57	5	\$ 17.85
PC68-DOT-46	1/4"	3/8"	29.1	27.1	11/16"	\$ 4.42	5	\$ 22.12
PC68-DOT-48	1/4"	1/2"	31.4	29.4	7/8"	\$ 7.04	5	\$ 35.22
PC68-DOT-62	3/8"	1/8"	28.9	26.9	5/8"	\$ 3.39	5	\$ 16.97
PC68-DOT-64	3/8"	1/4"	28.7	26.7	5/8"	\$ 3.39	5	\$ 16.97
PC68-DOT-66	3/8"	3/8"	29.1	27.1	11/16"	\$ 5.24	5	\$ 26.20
PC68-DOT-68	3/8"	1/2"	29.0	27	7/8"	\$ 6.44	5	\$ 32.22
PC68-DOT-612	3/8"	3/4"	33.7	31.7	27	\$ 14.65	5	\$ 73.24
PC68-DOT-84	1/2"	1/4"	34.7	32.7	13/16"	\$ 6.31	5	\$ 31.57
PC68-DOT-86	1/2"	3/8"	31.1	29.1	13/16"	\$ 6.66	5	\$ 33.29
PC68-DOT-88	1/2"	1/2"	33.4	31.4	7/8"	\$ 7.17	5	\$ 35.87
PC68-DOT-812	1/2"	3/4"	30.7	28.7	27	\$ 11.17	5	\$ 55.84
PC68-DOT-106	5/8"	3/8"	36	34	25	\$ 9.45	5	\$ 47.25
PC68-DOT-108	5/8"	1/2"	34.6	32.6	25	\$ 9.97	5	\$ 49.83
PC68-DOT-1012	5/8"	3/4"	34.7	32.7	27	\$ 11.81	5	\$ 59.06
PC68-DOT-128	3/4"	1/2"	41.4	39.4	27	\$ 11.86	5	\$ 59.28
PC68-DOT-1212	3/4"	3/4"	32.7	30.7	27	\$ 12.97	5	\$ 64.86

Measurements are in mm unless otherwise noted

## MALE ELBOW

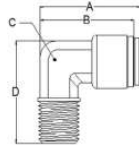

Part #	PI	NPT M	A	B	C	D	List Price	QTY	Pkg Price
PC69-DOT-42	1/4"	1/8"	27.9	25.9	9.2	23.5	\$ 3.99	5	\$ 19.97
PC69-DOT-44	1/4"	1/4"	28.2	26.2	12.5	30.5	\$ 5.11	5	\$ 25.56
PC69-DOT-46	1/4"	3/8"	30.8	28.8	12.5	30.5	\$ 5.76	5	\$ 28.78
PC69-DOT-62	3/8"	1/8"	29	27	12.5	28	\$ 5.71	5	\$ 28.57
PC69-DOT-64	3/8"	1/4"	29	27	12.5	30.5	\$ 5.84	5	\$ 29.21
PC69-DOT-66	3/8"	3/8"	31.5	29.5	12.5	30.5	\$ 6.53	5	\$ 32.65
PC69-DOT-68	3/8"	1/2"	35.5	33.5	15.5	38.5	\$ 9.11	5	\$ 45.53
PC69-DOT-84	1/2"	1/4"	36.6	34.6	15.5	35	\$ 9.32	5	\$ 46.61
PC69-DOT-86	1/2"	3/8"	36.6	34.6	15.5	35	\$ 9.71	5	\$ 48.54
PC69-DOT-88	1/2"	1/2"	38.6	36.6	15.5	39.5	\$ 10.35	5	\$ 51.76
PC69-DOT-106	5/8"	3/8"	40.9	38.9	19	38.5	\$ 13.92	5	\$ 69.59
PC69-DOT-108	5/8"	1/2"	40.9	38.9	19	42	\$ 14.73	5	\$ 73.67
PC69-DOT-128	3/4"	1/2"	50.2	48.2	20.5	47	\$ 16.88	5	\$ 84.47
PC69-DOT-1212	3/4"	3/4"					\$ 17.18	5	\$ 85.91

Measurements are in mm unless otherwise noted

## MALE ELBOW SWIVEL



Part #	Push-In	NPT M	List Price	QTY	Pkg Price
PC69-DOTS-42	1/4"	1/8"	\$ 5.67	5	\$ 28.35
PC69-DOTS-44	1/4"	1/4"	\$ 6.27	5	\$ 31.36
PC69-DOTS-46	1/4"	3/8"	\$ 6.36	5	\$ 31.79
PC69-DOTS-48	1/4"	1/2"	\$ 9.66	5	\$ 48.32
PC69-DOTS-62	3/8"	1/8"	\$ 6.62	5	\$ 33.08
PC69-DOTS-64	3/8"	1/4"	\$ 6.62	5	\$ 33.08
PC69-DOTS-66	3/8"	3/8"	\$ 7.30	5	\$ 36.51
PC69-DOTS-68	3/8"	1/2"	\$ 10.57	5	\$ 52.84
PC69-DOTS-612	3/8"	3/4"	\$ 16.80	5	\$ 83.98
PC69-DOTS-84	1/2"	1/4"	\$ 10.74	5	\$ 53.69
PC69-DOTS-86	1/2"	3/8"	\$ 11.43	5	\$ 57.13
PC69-DOTS-88	1/2"	1/2"	\$ 13.14	5	\$ 65.72
PC69-DOTS-812	1/2"	3/4"	\$ 13.14	5	\$ 65.72
PC69-DOTS-106	5/8"	3/8"	\$ 16.45	5	\$ 82.26
PC69-DOTS-108	5/8"	1/2"	\$ 17.53	5	\$ 87.63
PC69-DOTS-126	3/4"	3/8"	\$ 16.84	5	\$ 84.19
PC69-DOTS-128	3/4"	1/2"	\$ 17.78	5	\$ 88.92
PC69-DOTS-1212	3/4"	3/4"	\$ 17.61	5	\$ 88.06

## FEMALE ELBOW



Part #	Push-In	NPT F	List Price	QTY	Pkg Price
PC70-DOT-42	1/4"	1/8"	\$ 5.07	5	\$ 25.34
PC70-DOT-44	1/4"	1/4"	\$ 6.70	5	\$ 33.51
PC70-DOT-46	1/4"	3/8"	\$ 8.33	5	\$ 41.67
PC70-DOT-64	3/8"	1/4"	\$ 7.90	5	\$ 39.52
PC70-DOT-66	3/8"	3/8"	\$ 11.68	5	\$ 58.42
PC70-DOT-86	1/2"	3/8"	\$ 13.92	5	\$ 69.59
PC70-DOT-88	1/2"	1/2"	\$ 13.23	5	\$ 66.15

## FEMALE ELBOW SWIVEL



Part #	Push-In	NPT F	List Price	QTY	Pkg Price
PC70-DOTS-42	1/4"	1/8"	\$ 6.87	5	\$ 34.36
PC70-DOTS-44	1/4"	1/4"	\$ 7.00	5	\$ 35.01
PC70-DOTS-64	3/8"	1/4"	\$ 7.77	5	\$ 38.87

## MALE RUN TEE



Part #	Push-In	NPT M	List Price	QTY	Pkg Price
PC71-DOT-42	1/4"	1/8"	\$ 8.25	5	\$ 41.24
PC71-DOT-44	1/4"	1/4"	\$ 7.22	5	\$ 36.08
PC71-DOT-64	3/8"	1/4"	\$ 10.27	5	\$ 51.33
PC71-DOT-66	3/8"	3/8"	\$ 9.32	5	\$ 46.61
PC71-DOT-86	1/2"	3/8"	\$ 14.39	5	\$ 71.95
PC71-DOT-88	1/2"	1/2"	\$ 11.08	5	\$ 55.41

## MALE RUN TEE SWIVEL



Part #	Push-In	NPT M	List Price	QTY	Pkg Price
PC71-DOTS-42	1/4"	1/8"	\$ 11.51	5	\$ 57.56
PC71-DOTS-44	1/4"	1/4"	\$ 9.88	5	\$ 49.40
PC71-DOTS-64	3/8"	1/4"	\$ 11.68	5	\$ 58.42
PC71-DOTS-66	3/8"	3/8"	\$ 10.27	5	\$ 51.33
PC71-DOTS-86	1/2"	3/8"	\$ 19.33	5	\$ 96.65
PC71-DOTS-88	1/2"	1/2"	\$ 15.89	5	\$ 79.47

## MALE BRANCH TEE



Part #	Push-In	NPT M	List Price	QTY	Pkg Price
PC72-DOT-42	1/4"	1/8"	\$ 7.60	5	\$ 38.02
PC72-DOT-44	1/4"	1/4"	\$ 7.73	5	\$ 38.66
PC72-DOT-62	3/8"	1/8"	\$ 9.24	5	\$ 46.18
PC72-DOT-64	3/8"	1/4"	\$ 9.45	5	\$ 47.25
PC72-DOT-66	3/8"	3/8"	\$ 12.29	5	\$ 61.43
PC72-DOT-68	3/8"	1/2"	\$ 16.88	5	\$ 84.41
PC72-DOT-84	1/2"	1/4"	\$ 13.10	5	\$ 65.51
PC72-DOT-86	1/2"	3/8"	\$ 13.32	5	\$ 66.58
PC72-DOT-88	1/2"	1/2"	\$ 16.88	5	\$ 84.41

## MALE BRANCH TEE SWIVEL



Part #	Push-In	NPT M	List Price	QTY	Pkg Price
PC72-DOTS-42	1/4"	1/8"	\$ 10.61	5	\$ 53.05
PC72-DOTS-44	1/4"	1/4"	\$ 10.65	5	\$ 53.26
PC72-DOTS-46	1/4"	3/8"	\$ 12.46	5	\$ 62.29
PC72-DOTS-62	3/8"	1/8"	\$ 10.44	5	\$ 52.19
PC72-DOTS-64	3/8"	1/4"	\$ 10.74	5	\$ 53.69
PC72-DOTS-66	3/8"	3/8"	\$ 12.41	5	\$ 62.07
PC72-DOTS-84	1/2"	1/4"	\$ 11.73	5	\$ 58.63
PC72-DOTS-86	1/2"	3/8"	\$ 15.25	5	\$ 76.25
PC72-DOTS-88	1/2"	1/2"	\$ 17.40	5	\$ 86.98
PC72-DOTS-108	5/8"	1/2"	\$ 26.20	5	\$ 131.01

## FEMALE BRANCH TEE



Part #	Push-In	NPT F	List Price	QTY	Pkg Price
PC77-DOT-42	1/4"	1/8"	\$ 9.02	5	\$ 45.10
PC77-DOT-44	1/4"	1/4"	\$ 9.84	5	\$ 49.18
PC77-DOT-64	3/8"	1/4"	\$ 13.53	5	\$ 67.65
PC77-DOT-66	3/8"	3/8"	\$ 16.24	5	\$ 81.19

## FEMALE BRANCH TEE SWIVEL



Part #	Push-In	NPT F	List Price	QTY	Pkg Price
PC77-DOTS-42	1/4"	1/8"	\$ 11.77	5	\$ 58.85
PC77-DOTS-44	1/4"	1/4"	\$ 12.89	5	\$ 64.43
PC77-DOTS-64	3/8"	1/4"	\$ 13.70	5	\$ 68.51



Now that you have your tubing don't forget  
your D.O.T. fittings!  
Now available in Composite and Brass.



Polyconn® the one-stop shop for your  
pneumatic needs.