

# POLY CONN<sup>®</sup>

Servicing Your Pneumatic Needs For Over 40 Years

## TUBING ACCESSORIES

### EMAIL

[insidesales@polyconn.com](mailto:insidesales@polyconn.com)

### WEBSITE

[www.polyconn.com](http://www.polyconn.com)

### QUESTIONS

(763) 559-0388



# Features & Specifications for T-Clips

T-Clips provide a quick, adaptable and inexpensive answer to securing, attaching tubes, routing tubes, wires, hose and pipe. They allow installations to look extremely neat and professional. They are easy to install. T-Clips provide an exact, uniform spacing to dual runs and can be mounted on walls, cabinets, board enclosures and bulkheads. As many spacers as necessary may be stacked to provide the required height or clearance.

## FEATURES

- Center mounting hole for convenience.
- Precision injection molded acetal plastic.
- Provide quick, secure mounting with exact spacing between tubes.

## USES

- Many commercial applications such as installation of hydraulic or automotive hoses, electrical conduct, telephone wires, fiber optic cables and liquid/gas tubes/piping may benefit from the ease of installation, safety and appearance of job.

## SPECIFICATIONS

SPACER TEMPERATURE	T-CLIP TEMPERATURE	SPACER MATERIAL
-40°F to 212°F (-40°C - 100°C)	230°F (110°C)	Polyacetal engineered plastic with ultraviolet inhibitors

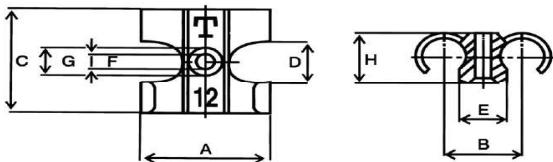

### Some industries where T-Clips are used include:

- Marine
- Machine Tools
- Plumbing
- Air Conditioning
- Pneumatics
- Refrigeration
- Appliances
- Construction
- Electrical
- Heating
- Robotics
- Hydraulics
- Automotive
- Medical Equipment
- Recreational Vehicles

Part #	Tube OD	A	B	C	D	E	F	G	H	List Price	QTY	Pkg. Price
PCT-4-2	5/32"	0.61	0.40	0.70	0.24	0.27	0.12	0.22	0.37	\$ 0.51	50	\$ 25.73
PCT-6-2	1/4"	0.811	0.506	0.808	0.324	0.334	0.122	0.262	0.364	\$ 0.66	50	\$ 32.75
PCT-8-2	5/16"	1.00	0.626	0.970	0.404	0.414	0.162	0.322	0.484	\$ 0.68	50	\$ 33.92
PCT-10-2	3/8"	1.21	0.74	1.09	0.46	0.43	0.16	0.32	0.56	\$ 0.71	50	\$ 35.68
PCT-12-2	1/2"	1.37	0.82	1.32	0.56	0.46	0.17	0.34	0.64	\$ 0.78	50	\$ 39.18
PCT-15-2	5/8"	1.70	1.03	1.60	0.66	0.55	0.20	0.40	0.78	\$ 1.15	50	\$ 57.31
PCT-18-2	3/4"	2.02	1.22	1.85	0.77	0.62	0.22	0.44	0.90	\$ 1.36	50	\$ 33.92
PCT-22-2	7/8"	2.45	1.50	2.36	0.88	0.78	0.25	0.49	1.08	\$ 1.87	50	\$ 46.78

# Features & Specifications for Tube Racks

Tube racks will keep your pneumatic hoses and tubes neat and in order. These sturdy plastic racks have 5, 7, or 10 tubing channels (depending on diameter) to clip hoses and tubes in place. The channels can easily be hand separated down to single holders. Tube racks from Polyconn will help avoid tangles and kinks in your pneumatic hoses, and will keep your multiple lines from turning into a jumbled mess.

## FEATURES

- Adhesive fastener available on 1/4" separable tube racks.
- Thru holes provided.
- Made from high density polyethylene

## USES

- Route and secure multiple tubing lines.
- Channels can easily be hand separated down to single holders.

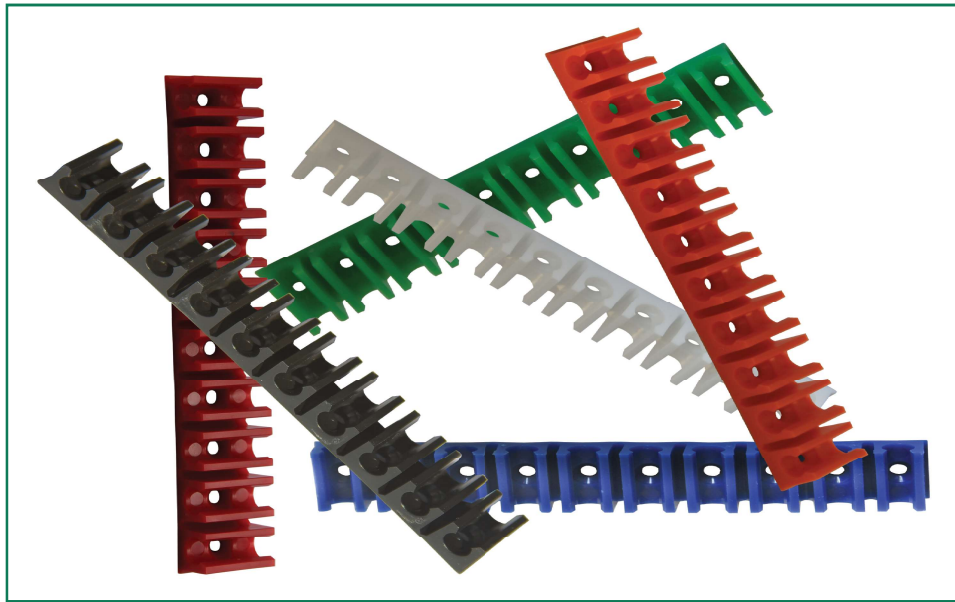

Part #	Tube OD	Mounting Hole Dia.	Features	Color	Channels	List Price	QTY	Pkg. Price
PCTR250-102	1/4"	0.115"	Non-Adhesive Back	Black	10	\$ 1.01	10	\$ 10.06
PCTR250-104	1/4"	0.115"	Non-Adhesive Back	Blue	10	\$ 0.40	10	\$ 3.98
PCTR250-105	1/4"	0.115"	Non-Adhesive Back	Green	10	\$ 0.40	10	\$ 3.98
PCTR250-106	1/4"	0.115"	Non-Adhesive Back	Yellow	10	\$ 0.40	10	\$ 3.98
PCTR250-107	1/4"	0.115"	Non-Adhesive Back	Orange	10	\$ 0.40	10	\$ 3.98
PCTR250-108	1/4"	0.115"	Non-Adhesive Back	Gray	10	\$ 0.40	10	\$ 3.98
PCTR250-112	1/4"	0.115"	Adhesive Back	Black	10	\$ 1.16	10	\$ 11.61
PCTR250-117	1/4"	0.115"	Adhesive Back	Orange	10	\$ 0.46	10	\$ 4.60
PCTR250-118	1/4"	0.115"	Adhesive Back	Gray	10	\$ 0.46	10	\$ 4.60
PCTR250-2	1/4"	N/A	Non-Separable	Black	10	\$ 0.46	10	\$ 4.60
PCTR375-2	3/8"	0.20"	Non-Separable	Black	7	\$ 6.52	10	\$ 65.20
PCTR500-2	1/2"	0.20"	Non-Separable	Black	5	\$ 2.92	10	\$ 29.17

# Features & Specifications for Tube Markers

Our tube markers are a quick and easy way to keep track of which tube is which in your system or facility. These small, cylindrical, white plastic markers snap on and off easily, and their coded black lettering is easy to read, even at a distance. Polyconn tube markers won't pinch, kink, or mar tubing. Numbers 0-9 and select capital letters are available, as well as markers with acronyms/abbreviations (CYL = cylinder, for example). We also sell kits with an assortment of alphanumeric or abbreviated markers included.

## FEATURES

- Will not pinch, kink, or mar tubing.
- Hot stamped and imprinted black coding on white background.
- Kits available.

## ORDERING INFORMATION

- Used to separate dust, dirt, moisture, and other contaminants from the compressed air line.
- Regulators are used to maintain a steady outlet pressure unaffected by fluctuations.



Part #	Tube OD	Imprint	List Price	QTY	Pkg. Price
TM1-0	5/32"	0	\$ 0.16	50	\$ 7.90
TM1-1	5/32"	1	\$ 0.16	50	\$ 7.90
TM1-2	5/32"	2	\$ 0.16	50	\$ 7.90
TM1-3	5/32"	3	\$ 0.16	50	\$ 7.90
TM1-4	5/32"	4	\$ 0.16	50	\$ 7.90
TM1-5	5/32"	5	\$ 0.16	50	\$ 7.90
TM1-6	5/32"	6	\$ 0.16	50	\$ 7.90
TM1-7	5/32"	7	\$ 0.16	50	\$ 7.90
TM1-8	5/32"	8	\$ 0.16	50	\$ 7.90
TM1-9	5/32"	9	\$ 0.16	50	\$ 7.90

Part #	Tube OD	Imprint	List Price	QTY	Pkg. Price
TM2-0	1/8"	0	\$ 0.15	50	\$ 7.25
TM2-1	1/8"	1	\$ 0.15	50	\$ 7.25
TM2-2	1/8"	2	\$ 0.15	50	\$ 7.25
TM2-3	1/8"	3	\$ 0.15	50	\$ 7.25
TM2-4	1/8"	4	\$ 0.15	50	\$ 7.25
TM2-5	1/8"	5	\$ 0.15	50	\$ 7.25
TM2-6	1/8"	6	\$ 0.15	50	\$ 7.25
TM2-7	1/8"	7	\$ 0.15	50	\$ 7.25
TM2-8	1/8"	8	\$ 0.15	50	\$ 7.25
TM2-9	1/8"	9	\$ 0.15	50	\$ 7.25

Part #	Tube OD	Imprint	List Price	QTY	Pkg. Price
TM4-0	1/4"	0	\$ 0.20	50	\$ 10.12
TM4-1	1/4"	1	\$ 0.20	50	\$ 10.12
TM4-2	1/4"	2	\$ 0.20	50	\$ 10.12
TM4-3	1/4"	3	\$ 0.20	50	\$ 10.12
TM4-4	1/4"	4	\$ 0.20	50	\$ 10.12
TM4-5	1/4"	5	\$ 0.20	50	\$ 10.12
TM4-6	1/4"	6	\$ 0.20	50	\$ 10.12
TM4-7	1/4"	7	\$ 0.20	50	\$ 10.12
TM4-8	1/4"	8	\$ 0.20	50	\$ 10.12
TM4-9	1/4"	9	\$ 0.20	50	\$ 10.12

Part #	Tube OD	Imprint	List Price	QTY	Pkg. Price
TM6-0	3/8"	0	\$ 0.40	50	\$ 20.24
TM6-1	3/8"	1	\$ 0.40	50	\$ 20.24
TM6-2	3/8"	2	\$ 0.40	50	\$ 20.24
TM6-3	3/8"	3	\$ 0.40	50	\$ 20.24
TM6-4	3/8"	4	\$ 0.40	50	\$ 20.24
TM6-5	3/8"	5	\$ 0.40	50	\$ 20.24
TM6-6	3/8"	6	\$ 0.40	50	\$ 20.24
TM6-7	3/8"	7	\$ 0.40	50	\$ 20.24
TM6-8	3/8"	8	\$ 0.40	50	\$ 20.24
TM6-9	3/8"	9	\$ 0.40	50	\$ 20.24

# ALPHA TUBE MARKERS



Part #	Tube OD	Imprint	List Price	QTY	Pkg. Price
TM1-A	5/32"	A	\$ 0.16	50	\$ 7.90
TM1-B	5/32"	B	\$ 0.16	50	\$ 7.90
TM1-C	5/32"	C	\$ 0.16	50	\$ 7.90
TM1-D	5/32"	D	\$ 0.16	50	\$ 7.90
TM1-E	5/32"	E	\$ 0.16	50	\$ 7.90
TM1-F	5/32"	F	\$ 0.16	50	\$ 7.90
TM1-G	5/32"	G	\$ 0.16	50	\$ 7.90
TM1-H	5/32"	H	\$ 0.16	50	\$ 7.90
TM1-J	5/32"	J	\$ 0.16	50	\$ 7.90
TM1-L	5/32"	L	\$ 0.16	50	\$ 7.90
TM1-P	5/32"	P	\$ 0.16	50	\$ 7.90
TM1-R	5/32"	R	\$ 0.16	50	\$ 7.90
TM1-S	5/32"	S	\$ 0.16	50	\$ 7.90
TM1-T	5/32"	T	\$ 0.16	50	\$ 7.90
TM1-X	5/32"	X	\$ 0.16	50	\$ 7.90
TM1-Y	5/32"	Y	\$ 0.16	50	\$ 7.90
TM1-Z	5/32"	Z	\$ 0.16	50	\$ 7.90

Part #	Tube OD	Imprint	List Price	QTY	Pkg. Price
TM2-A	1/8"	A	\$ 0.15	50	\$ 7.25
TM2-B	1/8"	B	\$ 0.15	50	\$ 7.25
TM2-C	1/8"	C	\$ 0.15	50	\$ 7.25
TM2-D	1/8"	D	\$ 0.15	50	\$ 7.25
TM2-E	1/8"	E	\$ 0.15	50	\$ 7.25
TM2-F	1/8"	F	\$ 0.15	50	\$ 7.25
TM2-G	1/8"	G	\$ 0.15	50	\$ 7.25
TM2-H	1/8"	H	\$ 0.15	50	\$ 7.25
TM2-J	1/8"	J	\$ 0.15	50	\$ 7.25
TM2-L	1/8"	L	\$ 0.15	50	\$ 7.25
TM2-M	1/8"	M	\$ 0.15	50	\$ 7.25
TM2-N	1/8"	N	\$ 0.15	50	\$ 7.25
TM2-P	1/8"	P	\$ 0.15	50	\$ 7.25
TM2-R	1/8"	R	\$ 0.15	50	\$ 7.25
TM2-S	1/8"	S	\$ 0.15	50	\$ 7.25
TM2-T	1/8"	T	\$ 0.15	50	\$ 7.25
TM2-V	1/8"	V	\$ 0.15	50	\$ 7.25
TM2-X	1/8"	X	\$ 0.15	50	\$ 7.25
TM2-Y	1/8"	Y	\$ 0.15	50	\$ 7.25
TM2-Z	1/8"	Z	\$ 0.15	50	\$ 7.25

Part #	Tube OD	Imprint	List Price	QTY	Pkg. Price
TM4-A	1/4"	A	\$ 0.20	50	\$ 10.12
TM4-B	1/4"	B	\$ 0.20	50	\$ 10.12
TM4-C	1/4"	C	\$ 0.20	50	\$ 10.12
TM4-D	1/4"	D	\$ 0.20	50	\$ 10.12
TM4-E	1/4"	E	\$ 0.20	50	\$ 10.12
TM4-F	1/4"	F	\$ 0.20	50	\$ 10.12
TM4-G	1/4"	G	\$ 0.20	50	\$ 10.12
TM4-H	1/4"	H	\$ 0.20	50	\$ 10.12
TM4-I	1/4"	I	\$ 0.20	50	\$ 10.12
TM4-J	1/4"	J	\$ 0.20	50	\$ 10.12
TM4-K	1/4"	K	\$ 0.20	50	\$ 10.12
TM4-L	1/4"	L	\$ 0.20	50	\$ 10.12
TM4-M	1/4"	M	\$ 0.20	50	\$ 10.12
TM4-N	1/4"	N	\$ 0.20	50	\$ 10.12
TM4-O	1/4"	O	\$ 0.20	50	\$ 10.12
TM4-P	1/4"	P	\$ 0.20	50	\$ 10.12
TM4-Q	1/4"	Q	\$ 0.20	50	\$ 10.12
TM4-R	1/4"	R	\$ 0.20	50	\$ 10.12
TM4-S	1/4"	S	\$ 0.20	50	\$ 10.12
TM4-T	1/4"	Y	\$ 0.20	50	\$ 10.12
TM4-U	1/4"	U	\$ 0.20	50	\$ 10.12
TM4-V	1/4"	V	\$ 0.20	50	\$ 10.12
TM4-W	1/4"	W	\$ 0.20	50	\$ 10.12
TM4-X	1/4"	X	\$ 0.20	50	\$ 10.12
TM4-Y	1/4"	Y	\$ 0.20	50	\$ 10.12
TM4-Z	1/4"	Z	\$ 0.20	50	\$ 10.12

Part #	Tube OD	Imprint	List Price	QTY	Pkg. Price
TM6-A	3/8"	A	\$ 0.40	50	\$ 20.24
TM6-B	3/8"	B	\$ 0.40	50	\$ 20.24
TM6-C	3/8"	C	\$ 0.40	50	\$ 20.24
TM6-D	3/8"	D	\$ 0.40	50	\$ 20.24
TM6-E	3/8"	E	\$ 0.40	50	\$ 20.24
TM6-F	3/8"	F	\$ 0.40	50	\$ 20.24
TM6-G	3/8"	G	\$ 0.40	50	\$ 20.24
TM6-H	3/8"	H	\$ 0.40	50	\$ 20.24
TM6-J	3/8"	J	\$ 0.40	50	\$ 20.24
TM6-P	3/8"	P	\$ 0.40	50	\$ 20.24
TM6-R	3/8"	R	\$ 0.40	50	\$ 20.24
TM6-X	3/8"	X	\$ 0.40	50	\$ 20.24
TM6-Y	3/8"	Y	\$ 0.40	50	\$ 20.24
TM6-Z	3/8"	Z	\$ 0.40	50	\$ 20.24

## LEGEND/CODE TUBE MARKERS



Part #	Tube OD	Imprint	List Price	QTY	Pkg. Price
TM1- -	5/32"	- (retract)	\$ 0.16	50	\$ 7.90
TM1- +	5/32"	+ (extend)	\$ 0.16	50	\$ 7.90
TM1-CYL	5/32"	CYL (cylinder)	\$ 0.28	50	\$ 13.83
TM1-IN	5/32"	IN (input)	\$ 0.24	50	\$ 11.87
TM1-LV	5/32"	LV (limit valve)	\$ 0.24	50	\$ 11.87
TM1-OUT	5/32"	OUT (output)	\$ 0.28	50	\$ 13.83
TM1-PV	5/32"	PV (power valve)	\$ 0.24	50	\$ 11.87

Part #	Tube OD	Imprint	List Price	QTY	Pkg. Price
TM2- -	1/8"	- (retract)	\$ 0.15	50	\$ 7.25
TM2- +	1/8"	+ (extend)	\$ 0.15	50	\$ 7.25
TM2-CYL	1/8"	CYL (cylinder)	\$ 0.25	50	\$ 12.69
TM2-IN	1/8"	IN (input)	\$ 0.22	50	\$ 10.88
TM2-LV	1/8"	LV (limit valve)	\$ 0.22	50	\$ 10.88
TM2-OUT	1/8"	OUT (output)	\$ 0.25	50	\$ 12.69
TM2-PV	1/8"	PV (power valve)	\$ 0.22	50	\$ 10.88

Part #	Tube OD	Imprint	List Price	QTY	Pkg. Price
TM4- -	1/4"	- (retract)	\$ 0.20	50	\$ 10.12
TM4- +	1/4"	+ (extend)	\$ 0.20	50	\$ 10.12
TM4-CYL	1/4"	CYL (cylinder)	\$ 0.35	50	\$ 17.72
TM4-IN	1/4"	IN (input)	\$ 0.30	50	\$ 15.21
TM4-LV	1/4"	LV (limit valve)	\$ 0.30	50	\$ 15.21
TM4-OUT	1/4"	OUT (output)	\$ 0.35	50	\$ 17.72
TM4-PV	1/4"	PV (power valve)	\$ 0.30	50	\$ 15.21

Part #	Tube OD	Imprint	List Price	QTY	Pkg. Price
TM6- -	3/8"	- (retract)	\$ 0.40	50	\$ 20.24
TM6- +	3/8"	+ (extend)	\$ 0.40	50	\$ 20.24
TM6-CYL	3/8"	CYL (cylinder)	\$ 0.71	50	\$ 35.41
TM6-IN	3/8"	IN (input)	\$ 0.61	50	\$ 30.35
TM6-LV	3/8"	LV (limit valve)	\$ 0.61	50	\$ 30.35
TM6-OUT	3/8"	OUT (output)	\$ 0.71	50	\$ 35.41
TM6-PV	3/8"	PV (power valve)	\$ 0.61	50	\$ 30.35

## TUBE MARKER KIT



### KIT 2 - ALPHA/NUMERIC

Part #	Tube OD	QTY	List Price
TM1-KIT2	5/32"	1	\$ 193.50
TM2-KIT2	1/8"	1	\$ 196.67
TM4-KIT2	1/4"	1	\$ 330.00
TM6-KIT2	3/8"	1	\$ 442.11

Kit 2 contains 50 of each Alpha/Numeric markers listed below.

Imprint	QTY
0	50
1	50
2	50
3	50
4	50
5	50
6	50
7	50
8	50
9	50

Imprint	QTY
A	50
B	50
C	50
D	50
E	50
F	50
G	50
H	50
J	50
P	50
R	50
X	50
Y	50
Z	50

### KIT 2 - LEGEND/CODE

Part #	Tube OD	QTY	List Price
TM1-KIT3	5/32"	1	\$ 75.11
TM2-KIT3	1/8"	1	\$ 68.89
TM4-KIT3	1/4"	1	\$ 96.22
TM6-KIT3	3/8"	1	\$ 192.22

Kit 2 contains 50 of each Legend/Code markers listed below.

Imprint	QTY
CYL (cylinder)	50
PV (power valve)	50
LV (limit valve)	50
IN (input)	50
OUT (output)	50
+ (extend)	50
- (retract)	50

## TUBE CUTTER

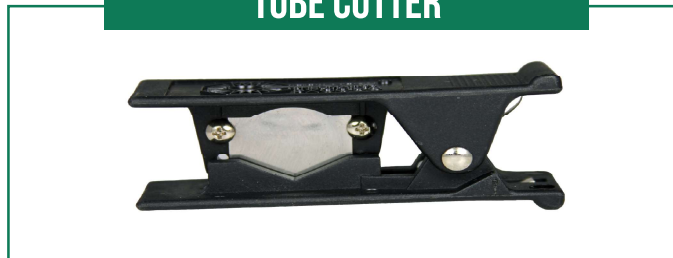

Part #	Tube OD	QTY	List Price
PCTC-1000	TUBE CUTTER	1	\$ 13.78
PCRB-1000	REPLACEMENT BLADES 5/PK	1	\$ 22.52

Now that you have your accessories don't forget  
your tubing!



**POLY<sup>®</sup>  
CONN**

*Servicing Your Pneumatic Needs For Over 40 Years*

**Polyconn<sup>®</sup> the one-stop shop for your  
pneumatic needs.**