

# POLY CONN<sup>®</sup>

Servicing Your Pneumatic Needs For Over 40 Years

## METRIC PRODUCTS

### EMAIL

[insidesales@polyconn.com](mailto:insidesales@polyconn.com)

### WEBSITE

[www.polyconn.com](http://www.polyconn.com)

### QUESTIONS

(763) 559-0388



# TABLE OF CONTENTS

Page 3-4: Polyurethane Tubing .....

Page 5: Polyethylene Tubing .....

Page 6: Nylon Tubing .....

Page 7: Kynar Tubing .....

Page 8: Fluorinated Ethylene  
Propylene - FEP Tubing .....

Page 9: Static Dissipative Tubing .....

Page 10: Weld Spatter Tubing .....

Page 11-13: Stainless Steel  
PTC Fittings .....

Page 14-17: Composite Metric  
PTC Fittings .....

Page 14-17: Composite Transition  
PTC Fittings .....



# Features and Specifications for Polyurethane Tubing

Polyurethane has a high resistance to abrasion while being highly flexible and kink resistant. Its most notable quality though is its “memory”. This tubing will stretch and flex but always return to its original shape. It is available in 23 standard colors. This versatile tubing is used for everything from high pressure applications to medical uses to situations where flexibility is key. Depending on durometer and size, Polyconn’s polyurethane tubing can be used with push-in or barbed fittings.



\*Special Note - Not all colors pictured above may be available, please call us for availability.

◆denotes color code. To select color by code please refer to Standard Available Colors chart below.

## FEATURES

- Naturally clear tubing with a broad resistance to chemicals, water, fuel, oil and fungus.
- Polyurethane has a tensile strength twice that of vinyl tubing and is suitable for air logic applications.
- It is highly flexible, kink resistant with an incredible memory.
- A large range of sizes, colors, configurations, and packaging options to fulfill your needs.

## USES

- It is ideal to use barb fittings with Polyurethane 85A and Polyurethane 90A tubing.
- 85A and 90A offer a rubber like feel with no plasticizers to leach or migrate. This ensures a long stable service life.
- Barb and Push to Connect fittings can be used with Polyurethane 95A tubing.

## SPECIFICATIONS

TEMPERATURE RANGE	WORKING PRESSURE	VACUUM RATING	UV STABILIZED
-40°F - 165°F (-40°C - 74°C)	3:1 Safety Factor	To -28” Hg	Yes



# Features and Specifications for Polyethylene Tubing

Linear Low Density Polyethylene or LLDPE's greatest advantage over any other low density polyethylene is its superior environmental stress crack resistance (ESCR). Environmental stresses that can shorten the service life of tubing includes: chemical exposure, aging, connection to barb-type fittings, or high vibration connections with compression fittings. All colors comply with FDA regulation 21 CFR 177.1520(c) for food contact applications.



\*Special Note - Not all colors pictured above may be available, please call us for availability.

◆denotes color code. To select color by code please refer to Standard Available Colors chart below.

## FEATURES

- Greater tensile strength.
- High burst pressure.
- Superior stress and crack resistance.
- Tasteless and odorless.
- Puncture resistance.
- Impermeable to some gasses and moisture.
- Superior dielectric properties.
- Lightweight.

## USES

- Push to Connect and Compression fittings can be used with Polyethylene.

## SPECIFICATIONS

TEMPERATURE RANGE	WORKING PRESSURE	VACUUM RATING	HARDNESS
-40°F - 150°F (-40°C - 66°C)	3:1 Safety Factor	To -28" Hg	50 Shore D

## POLYETHYLENE TUBING

Part #	OD	ID	Wall	Standard Colors	Working Pressure		Bend Radius	List Price	PKG QTY	Pkg Price
					@ 75°F	@ 150°F				
PCEM-4PG-◆	4 mm	2.7 mm	.65 mm	① ② ③ ④ ⑤ ⑥	175 PSI	70 PSI	25.2 mm	\$ 0.23	100'	\$ 22.66
PCEM-4PG-◆-R								\$ 0.21	500'	\$ 103.80
PCEM-4PG-◆-LR								\$ 0.19	1000'	\$ 188.80
PCEM-6PG-◆	6 mm	4 mm	1 mm	① ② ④	175 PSI	70 PSI	31.8 mm	\$ 0.23	100'	\$ 22.84
PCEM-6PG-◆-R								\$ 0.21	500'	\$ 105.55
PCEM-6PG-◆-LR								\$ 0.19	1000'	\$ 190.60
PCEM-8PG-◆	8 mm	6 mm	1 mm	① ② ③ ④	140 PSI	55 PSI	38 mm	\$ 0.29	100'	\$ 29.19
PCEM-8PG-◆-R								\$ 0.25	500'	\$ 127.05
PCEM-10PG-◆	10 mm	8 mm	1 mm	① ② ④	115 PSI	45 PSI	51 mm	\$ 0.38	100'	\$ 37.77
PCEM-10PG-◆-R								\$ 0.34	500'	\$ 169.05
PCEM-12PG-◆	12 mm	9 mm	1.5 mm	① ② ④	135 PSI	55 PSI	63 mm	\$ 0.56	100'	\$ 56.31
PCEM-12PG-◆-SR								\$ 0.51	250'	\$ 126.55
PCEM-12PG-◆-R								\$ 0.49	500'	\$ 242.90

# Features and Specifications for Nylon Tubing

Nylon tubing can withstand higher temperatures, making it an ideal choice for a wide variety of applications. When compared to other Nylon resins this tubing allows for a lighter weight wall, greater flexibility and smaller bend radius. It is also more corrosion resistant than other types of Nylon tubing because of its resistance moisture absorption. It's heat and UV stabilization makes it resistant to stress-cracking, so it works well in sunny areas. It is chemical resistant which makes it a good choice in areas where exposure to certain chemicals is a possibility.



\*Special Note - Not all colors pictured above may be available, please call us for availability.

◆denotes color code. To select color by code please refer to Standard Available Colors chart below.

## FEATURES

- Strong, lightweight and flexible.
- Dimensionally stable.
- Heat and light stable.
- Resistant to corrosion and stress cracking.

## USES

- Push to Connect and Compression fittings can be used with Nylon tubing.

## SPECIFICATIONS

TEMPERATURE RANGE	WORKING PRESSURE	VACUUM RATING	HARDNESS
-60°F - 200°F (-51°C - 93°C)	4:1 Safety Factor	To -28" Hg	78 Rockwell R

## NYLON TUBING

Part #	OD	ID	Wall	Standard Colors	Working Pressure		Bend Radius	List Price	PKG QTY	Pkg Price
					@ 75°F	@ 150°F				
PCNM-4N-◆	4 mm	2.7 mm	.65 mm	① ② ③ ④ ⑤	350 PSI	210 PSI	12.7 mm	\$ 0.27	100'	\$ 27.02
PCNM-4N-◆-R				⑥ ⑦ ⑪ ⑬				\$ 0.24	500'	\$ 121.05
PCNM-4N-◆-LR				\$ 0.14				1000'	\$ 236.40	
PCNM-5N-◆	5 mm	3 mm	1 mm	① ② ③ ④ ⑤ ⑥	420 PSI	250 PSI	9.5 mm	\$ 0.47	100'	\$ 46.89
PCNM-6N-◆	6 mm	4 mm	1 mm	① ② ③ ④ ⑤ ⑥ ⑦	340 PSI	200 PSI	17 mm	\$ 0.55	100'	\$ 55.15
PCNM-6N-◆-R								\$ 0.53	500'	\$ 262.60
PCNM-6N-◆-LR								\$ 0.47	1000'	\$ 474.70
PCNM-8N-◆	8 mm	6 mm	1 mm	① ② ③ ④ ⑤ ⑥	250 PSI	150 PSI	38 mm	\$ 0.75	100'	\$ 75.04
PCNM-8N-◆-R								\$ 0.67	500'	\$ 336.70
PCNM-10N-◆	10 mm	8 mm	1 mm	① ② ⑬	190 PSI	110 PSI	51 mm	\$ 0.96	100'	\$ 96.22
PCNM-10N-◆-R								\$ 0.87	500'	\$ 432.50
PCNM-12N-◆	12 mm	10 mm	1 mm	① ②	150 PSI	90 PSI	63 mm	\$ 1.17	100'	\$ 116.68

# Features and Specifications for Kynar PVDF Tubing

Kynar® PVDF compound is an economical alternative to Teflon (PTFE, PFA, and FEP) tubing for applications not requiring heat resistance. Kynar® possesses excellent resistance to a wide range of chemicals. The high purity material is the ideal tubing for a variety of applications requiring an odorless and tasteless tube.



## FEATURES

- Resists:  
Acids, Alcohol, Aliphatics, Aromatics, Chloride, Fungus, Mild Bases, Out-gassing, Radiation, and UV Light.
- Sterilizable by Gamma Radiation or Ozone.
- Resists fungal growth per MS 810B, Method 508 testing.

## USES

- Well suited for medical, pharmaceutical, food & beverage, deionized water systems, semiconductor processing, wastewater treatment, pulp & paper bleaching.

## SPECIFICATIONS

TEMPERATURE RANGE	WORKING PRESSURE	VACUUM RATING	HARDNESS
-40°F - 180°F (-40°C - 82°C)	4:1 Safety Factor	To -28" Hg	65 Shore D

## KYNAR PVDF TUBING

Part #	OD	ID	Wall	Standard Colors	Working Pressure		Bend Radius	List Price	PKG QTY	Pkg Price
					@ 75°F	@ 150°F				
PCKM-6K-0	6 mm	4 mm	1 mm		195 PSI	115 PSI	15.9 mm	\$ 1.63	100'	\$ 163.40
PCKM-6K-0-R								\$ 1.60	500'	\$ 798.85

# Features and Specifications for Fluorinated Ethylene Propylene - FEP Tubing

FEP tubing is one of the most durable and versatile flexible plastic tubes that you can buy. FEP, or fluorinated ethylene propylene, is an economical choice for applications requiring chemical resistance or exposure to a wide range of temperatures. FEP is extremely flexible, making it an ideal choice for self-retracting coils.



## FEATURES

- 100% virgin grade high performance resin designed to resist stress cracking.
- Low permeability.
- High thermal stability and UV resistant.
- Non-flammable/Self-extinguishing.
- Superior electrical insulation properties.
- Chemically inert to most industrial chemicals and solvents.

## USES

- Chemical Processing
- Laboratory applications
- Medical devices
- Water purification
- Food processing
- Automotive paint spray

## SPECIFICATIONS

TEMPERATURE RANGE	WORKING PRESSURE	VACUUM RATING	HARDNESS
-100°F - 400°F (-73°C - 204°C)	5:1 Safety Factor	To -28" Hg	57 Shore D

## FEP TUBING

Part #	OD	ID	Wall	Standard Colors	Working Pressure @ 75°F	Bend Radius	List Price	PKG QTY	Pkg Price
PCFM-4P-0	4 mm	2 mm	1 mm		450 PSI	1.5"	\$ 3.64	100'	\$ 363.73
PCFM-4P-0-LR							\$ 3.60	1000'	\$ 3,597.43
PCFM-4P-0-XR							\$ 3.54	2500'	\$ 8,856.30
PCFM-6P-0	6 mm	4 mm	1 mm		301 PSI	1"	\$ 4.42	100'	\$ 441.64
PCFM-6P-0-R							\$ 4.39	500'	\$ 2,195.50
PCFM-6P-0-XR							\$ 4.35	2500'	\$ 10,863.88
PCFM-8P-0	8 mm	6 mm	1 mm		225 PSI	2.5"	\$ 5.58	100'	\$ 558.29
PCFM-8P-0-LR							\$ 5.48	1500'	\$ 8,218.96
PCFM-10P-0							\$ 7.30	100'	\$ 729.77
PCFM-10P-0-LR	10 mm	8 mm	1 mm		125 PSI	2.75"	\$ 7.20	1500'	\$ 10,804.50



# Features and Specifications for Static Dissipative Tubing

Static electricity is a stationary charge of electricity resting on an object's surface. With plastic tubing, the charge is usually generated by friction on the exterior or interior of the tubing. The charge is typically localized. This means that a charge may exist on one part of the tube but not the entire tube. The spotty nature of the charge makes it much harder to detect. Furthermore, humans can only sense electrostatic discharge (ESD) greater than 3,500 electrostatic volts. A charge as low as 100 ESD volts can damage certain circuits meaning that electronics can be destroyed by ESD without the person even knowing it.

Static Dissipative Polyurethane tubing is made from an ether-based polyurethane that is specially formulated to help control ESD. It should always be used in low humidity environments or when tubing is going to be near circuit boards.



\*Special Note - Not all colors pictured above may be available, please call us for availability.

◆denotes color code. To select color by code please refer to Standard Available Colors chart below.

## FEATURES

- Dissipates electrostatic charges with no chemical additives.
- Contains no conductive fillers and no particle emission.
- Dissipative values are permanent and cannot be washed away.
- Non-Contaminating and non-outgassing.
- Ideal for low humidity environments.
- Non-corrosive to electronic leads and components.

## USES

- Barb fittings are the suggested fittings to use with the static dissipative polyurethane tubing.

## SPECIFICATIONS

TEMPERATURE RANGE	WORKING PRESSURE	VACUUM RATING	UV STABILIZED
-40°F - 165°F (-40°C - 73°C)	3:1 Safety Factor	To -28" Hg	Yes

## STATIC DISSIPATIVE TUBING

Part #	OD	ID	Wall	Standard Colors	Working Pressure		Bend Radius	List Price	PKG QTY	Pkg Price
					@ 75°F	@ 150°F				
PCUM-4SDT-◆	4 mm	2.4 mm	0.8 mm	2 3 4 7 10	105 PSI	50 PSI	9.5 mm	\$ 0.52	100'	\$ 52.37
PCUM-6SDT-◆-LR	6 mm	4 mm	1 mm	2 4 7 9	90 PSI	45 PSI	12.7 mm	\$ 0.85	1000'	\$ 847.50
PCUM-8SDT-◆-R	8 mm	5 mm	1.5 mm	2 4	100 PSI	50 PSI	19 mm	\$ 1.51	500'	\$ 757.45
PCUM-12SDT-◆-SR	12 mm	8 mm	2 mm	2	90 PSI	45 PSI	28.6 mm	\$ 3.05	250'	\$ 762.75

# Features and Specifications for Weld Spatter Tubing

Weld-Spatter Resistant tubing is made by taking blue 95A durometer polyurethane tubing and jacketing it with a specially formulated weld-spatter resistant cover. The result is a jacketed tube that resists incidental weld spatter contact. The outer cover base resin meets UL94V0 requirements and offers strong insulating properties. It also resists oils, greases, acids, bases, aqueous solutions, ozone, heat-aging and ultraviolet light. The cover is approximately .030" thick and does not adhere to the inner tube, allowing the jacket to be easily skived back for fitting connection with conventional compression or push to connect fittings.



\*Special Note - Not all colors pictured above may be available, please call us for availability.

◆denotes color code. To select color by code please refer to Standard Available Colors chart below.

## FEATURES

- Protects tube from incidental weld spatter contact.
- Flexible with an excellent bend radius.
- Resistant to kink damage.
- Broad range of chemical resistance.

## USES

- Ideal for use on machine tools, pneumatic plumbing systems, water and air lines on automatic or spot welders.
- Push to connect, compression, and barb fittings are the suggested fittings to use.

## SPECIFICATIONS

TEMPERATURE RANGE	WORKING PRESSURE	VACUUM RATING	RESIN COMPLIANCE
-40°F - 165°F (-40°C - 73°C)	3:1 Safety Factor	To -28" Hg	Outer Jacket: UL94V0 Inner Tube: UL94HB

## WELD SPATTER TUBING

Part #	OD	ID	Standard Colors	Working Pressure		Bend Radius	List Price	PKG QTY	Pkg Price
				@ 75°F	@ 150°F				
PCUM-6WSR-◆	6 mm	4 mm	④	160 PSI	65 PSI	12.7 mm	\$ 1.79	100'	\$ 178.97
PCUM-6WSR-◆-SR							\$ 1.75	250'	\$ 437.40
PCUM-8WSR-◆	8 mm	5 mm	②④⑨	190 PSI	75 PSI	19 mm	\$ 2.07	100'	\$ 206.65
PCUM-8WSR-◆-R							\$ 1.99	500'	\$ 993.45
PCUM-10WSR-◆	10 mm	6.5 mm	②④	170 PSI	70 PSI	22.2 mm	\$ 2.44	100'	\$ 244.47
PCUM-10WSR-◆-R							\$ 2.37	500'	\$ 1,182.55
PCUM-12WSR-◆-50	12 mm	8 mm	②	155 PSI	60 PSI	28.66 mm	\$ 3.68	50'	\$ 183.84
PCUM-12WSR-◆-SR							\$ 3.60	250'	\$ 899.78

# Features and Specifications for Stainless Steel Push to Connect Fittings

This stainless steel line is a great choice to use when acetal, brass, and or nickel plated brass fittings can not be used. The 316 stainless steel that is used in these fittings is designed to withstand corrosive environments or substances, to channel agresive fluids and to be used in the food, pharmaceutical and chemical industries. These fittings come with Viton O-Ring to guarantee the best performance.

## SPECIFICATIONS

TEMPERATURE RANGE	PRESSURE RATING	VACUUM RATING
-4°F - 356°F (-20°C - 180°C)	250 PSI	To -30" Hg

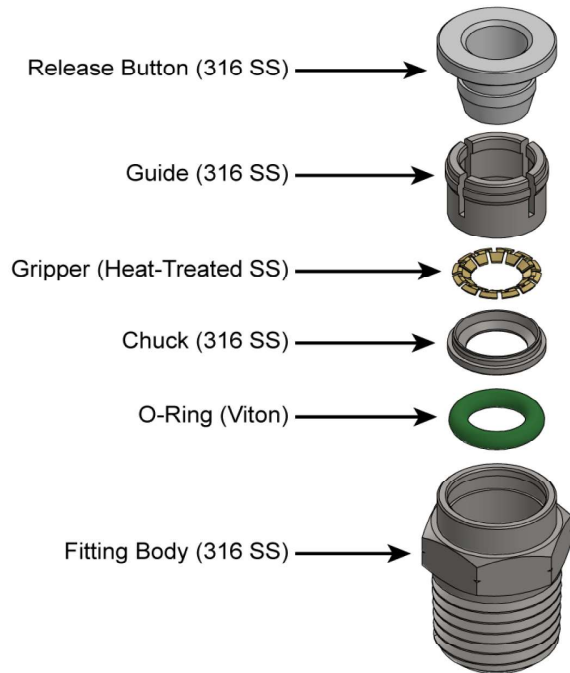

## PLUG



Part #	Push-In	QTY	List Price
PC59SSM-6-316	6 mm	1	\$ 2.59
PC59SSM-10-316	10 mm	1	\$ 2.59
PC59SSM-12-316	12 mm	1	\$ 2.59

## UNION TUBE



Part #	Push-In	QTY	List Price
PC62SSM-4-316	4 mm	1	\$ 16.12
PC62SSM-6-316	6 mm	1	\$ 16.10
PC62SSM-8-316	8 mm	1	\$ 17.55
PC62SSM-10-316	10 mm	1	\$ 19.01
PC62SSM-12-316	12 mm	1	\$ 23.03

## UNION TEE



Part #	Push-In	QTY	List Price
PC64SSM-4-316	4 mm	1	\$ 31.42
PC64SSM-6-316	6 mm	1	\$ 36.12
PC64SSM-8-316	8 mm	1	\$ 40.78
PC64SSM-10-316	10 mm	1	\$ 45.41
PC64SSM-12-316	12 mm	1	\$ 53.12

### UNION TEE



Part #	Push-In	QTY	List Price
PC65SSM-4-316	4 mm	1	\$ 25.60
PC65SSM-6-316	6 mm	1	\$ 29.41
PC65SSM-8-316	8 mm	1	\$ 30.74
PC65SSM-10-316	10 mm	1	\$ 33.53
PC65SSM-12-316	12 mm	1	\$ 38.57

### FEMALE CONNECTOR



Part #	Push-In	BSPT F	QTY	List Price
PC66SSM-4M5-316	4 mm	M5	1	\$ 13.04
PC66SSM-42R-316	4 mm	1/8"	1	\$ 13.04
PC66SSM-44R-316	4 mm	1/4"	1	\$ 13.04
PC66SSM-6M5-316	6 mm	M5	1	\$ 13.04
PC66SSM-62R-316	6 mm	1/8"	1	\$ 13.04
PC66SSM-64R-316	6 mm	1/4"	1	\$ 13.04
PC66SSM-84R-316	8 mm	1/4"	1	\$ 16.75
PC66SSM-86R-316	8 mm	3/8"	1	\$ 18.42
PC66SSM-104R316	10 mm	1/4"	1	\$ 20.12
PC66SSM-106R316	10 mm	3/8"	1	\$ 21.48
PC66SSM-126R316	12 mm	3/8"	1	\$ 22.50
PC66SSM-128R316	12 mm	1/2"	1	\$ 25.89

### MALE CONNECTOR



Part #	Push-In	BSPT F	QTY	List Price
PC68SSM-4M5-316	4 mm	M5	1	\$ 11.18
PC68SSM-42R-316	4 mm	1/8"	1	\$ 11.18
PC68SSM-44R-316	4 mm	1/4"	1	\$ 12.87
PC68SSM-6M5-316	6 mm	M5	1	\$ 12.87
PC68SSM-62R-316	6 mm	1/8"	1	\$ 12.87
PC68SSM-64R-316	6 mm	1/4"	1	\$ 12.87
PC68SSM-84R-316	8 mm	1/4"	1	\$ 14.88
PC68SSM-86R-316	8 mm	3/8"	1	\$ 15.71
PC68SSM-104R316	10 mm	1/4"	1	\$ 14.88
PC68SSM-106R316	10 mm	3/8"	1	\$ 15.10
PC68SSM-126R316	12 mm	3/8"	1	\$ 18.23
PC68SSM-128R316	12 mm	1/2"	1	\$ 24.05

### MALE ELBOW SWIVEL



Part #	Push-In	BSPT F	QTY	List Price
PC69SSM-4M5-316	4 mm	M5	1	\$ 22.23
PC69SSM-42R-316	4 mm	1/8"	1	\$ 22.23
PC69SSM-44R-316	4 mm	1/4"	1	\$ 22.23
PC69SSM-6M5-316	6 mm	M5	1	\$ 25.60
PC69SSM-62R-316	6 mm	1/8"	1	\$ 23.68
PC69SSM-64R-316	6 mm	1/4"	1	\$ 25.60
PC69SSM-84R-316	8 mm	1/4"	1	\$ 28.41
PC69SSM-86R-316	8 mm	3/8"	1	\$ 28.61
PC69SSM-104R316	10 mm	1/4"	1	\$ 29.62
PC69SSM-106R316	10 mm	3/8"	1	\$ 30.74
PC69SSM-126R316	12 mm	3/8"	1	\$ 37.79
PC69SSM-128R316	12 mm	1/2"	1	\$ 43.03

### TEE RUN SWIVEL



Part #	Push-In	BSPT F	QTY	List Price
PC71SSM-4M5-316	4 mm	M5	1	\$ 31.42
PC71SSM-42R-316	4 mm	1/8"	1	\$ 31.42
PC71SSM-44R-316	4 mm	1/4"	1	\$ 31.42
PC71SSM-6M5-316	6 mm	M5	1	\$ 31.42
PC71SSM-62R-316	6 mm	1/8"	1	\$ 31.42
PC71SSM-64R-316	6 mm	1/4"	1	\$ 36.12
PC71SSM-84R-316	8 mm	1/4"	1	\$ 39.49
PC71SSM-86R-316	8 mm	3/8"	1	\$ 42.91
PC71SSM-104R316	10 mm	1/4"	1	\$ 45.41
PC71SSM-106R316	10 mm	3/8"	1	\$ 45.41
PC71SSM-126R316	12 mm	3/8"	1	\$ 53.12
PC71SSM-128R316	12 mm	1/2"	1	\$ 53.12



# Features and Specifications for Composite Metric Push to Connect Fittings

Our metric composite fittings can be used in a variety of applications such as industrial, robotics, machinery, mobile and instrumentation. Polyconn offers a broad range of metric composite push-in pneumatic fittings. The metric composite fittings, offer a way to connect tubing quickly and easily with no need for tools.

Polyconn's CB composite fittings use a stainless-steel gripping-ring to grip nylon, 95 durometer polyurethane and polyethylene tubing. The nickel plated brass components on the fittings help to provide corrosion resistance and assist in prolonging the life of the fitting. All of the tapered threads come with pre-applied thread sealant and our parallel threads come with a recessed captive o-ring.

The advanced design of the Polyconn push-in fitting places more gripper teeth in the fitting that are independent of the collet. This superior method allows the collet to guide and center the tubing into the fitting teeth on connection. When the need arises to disconnect, simply depress the collet which slides down and pushes the teeth entirely out of the way, disengaging the tubing completely.

## SPECIFICATIONS

TEMPERATURE RANGE	PRESSURE RANGE	VACUUM RATING
32°F - 140°F (0°C - 60°C)	0 - 150 PSI	TO -29.5" Hg

## FEATURES

- Collet detents fully retracting gripper teeth.
- An oval collet makes it easier to disengage tubing.
- Custom colored collets available upon request.
- Body material nickel plated brass and black PBT (Polybutylene).
- Locking ring stainless steel.
- O-Ring NBR
- Working pressure 150 PSI.
- Pre-applied thread sealant.

## USES

- Industrial
- Robotics
- Machinery
- Mobile
- Instrumentation

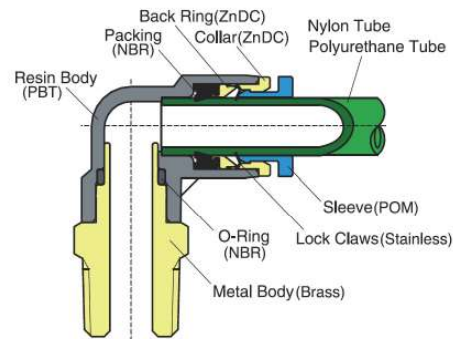

### UNION Y



Part #	Push-In	List Price	QTY	Pkg Price
PC45CBM-4	4 MM	\$ 1.17	5	\$ 5.85
PC45CBM-6	6 MM	\$ 1.17	5	\$ 5.85
PC45CBM-8	8 MM	\$ 1.17	5	\$ 5.85
PC45CBM-12	12 MM	\$ 2.05	5	\$ 10.22

### UNION TUBE REDUCER



Part #	PI A	PI B	List Price	QTY	Pkg Price
PC62CBMR-46	4 MM	6 MM	\$ 0.98	5	\$ 4.91
PC62CBMR-68	6 MM	8 MM	\$ 1.22	5	\$ 6.08
PC62CBMR-810	8 MM	10 MM	\$ 1.40	5	\$ 7.02

### UNION Y REDUCER



Part #	PI A	PI B	List Price	QTY	Pkg Price
PC45CBMR-46	4 MM	6 MM	\$ 1.78	5	\$ 8.89
PC45CBMR-68	6 MM	8 MM	\$ 1.68	5	\$ 8.40

### UNION TEE



Part #	Push-In	List Price	QTY	Pkg Price
PC64CBM-4	4 MM	\$ 1.26	5	\$ 6.32
PC64CBM-6	6 MM	\$ 1.26	5	\$ 6.32
PC64CBM-8	8 MM	\$ 1.31	5	\$ 6.55
PC64CBM-10	10 MM	\$ 1.82	5	\$ 9.12
PC64CBM-12	12 MM	\$ 2.20	5	\$ 10.99
PC64CBM-16	16 MM	\$ 4.70	5	\$ 23.51

### PLUG



Part #	Push-In	List Price	QTY	Pkg Price
PC59CBM-4	4 MM	\$ 0.56	5	\$ 2.81
PC59CBM-6	6 MM	\$ 0.56	5	\$ 2.81
PC59CBM-8	8 MM	\$ 0.66	5	\$ 3.28
PC59CBM-10	10 MM	\$ 0.89	5	\$ 4.44
PC59CBM-12	12 MM	\$ 1.03	5	\$ 5.15

### UNION ELBOW



Part #	Push-In	List Price	QTY	Pkg Price
PC65CBM-4	4 MM	\$ 0.84	5	\$ 4.21
PC65CBM-6	6 MM	\$ 0.89	5	\$ 4.44
PC65CBM-8	8 MM	\$ 1.12	5	\$ 5.61
PC65CBM-10	10 MM	\$ 1.36	5	\$ 6.78
PC65CBM-12	12 MM	\$ 1.54	5	\$ 7.72
PC65CBM-16	16 MM	\$ 4.81	5	\$ 24.07

### UNION TUBE



Part #	Push-In	List Price	QTY	Pkg Price
PC62CBM-4	4 MM	\$ 0.84	5	\$ 4.21
PC62CBM-6	6 MM	\$ 0.89	5	\$ 4.44
PC62CBM-8	8 MM	\$ 1.08	5	\$ 5.38
PC62CBM-10	10 MM	\$ 1.36	5	\$ 6.78
PC62CBM-12	12 MM	\$ 1.56	5	\$ 7.72
PC62CBM-16	16 MM	\$ 3.51	5	\$ 17.57

### METRIC MALE CONNECTOR



Part #	Push-In	M Thread	List Price	QTY	Pkg Price
PC68CBM-04M5	4 MM	M 5	\$ 0.90	5	\$ 4.51
PC68CBM-04M6	4 MM	M 6	\$ 0.94	5	\$ 4.68
PC68CBM-06M5	6 MM	M 5	\$ 1.10	5	\$ 5.52
PC68CBM-06M6	6 MM	M 6	\$ 1.23	5	\$ 6.14

**MALE CONNECTOR  
MM X BSPP**



Part #	Push-In	BSPP	List Price	QTY	Pkg Price
PC68CBM-42G	4 MM	1/8"	\$ 1.10	5	\$ 5.50
PC68CBM-44G	4 MM	1/4"	\$ 1.68	5	\$ 8.40
PC68CBM-62G	6 MM	1/8"	\$ 1.22	5	\$ 6.08
PC68CBM-64G	6 MM	1/4"	\$ 1.73	5	\$ 8.66
PC68CBM-66G	6 MM	3/8"	\$ 2.36	5	\$ 11.79
PC68CBM-68G	6 MM	1/2"	\$ 3.83	5	\$ 19.13
PC68CBM-82G	8 MM	1/8"	\$ 1.62	5	\$ 8.12
PC68CBM-84G	8 MM	1/4"	\$ 1.59	5	\$ 7.95
PC68CBM-86G	8 MM	3/8"	\$ 2.36	5	\$ 11.79
PC68CBM-88G	8 MM	1/2"	\$ 4.14	5	\$ 20.70
PC68CBM-102G	10 MM	1/8"	\$ 2.31	5	\$ 11.53
PC68CBM-104G	10 MM	1/4"	\$ 2.36	5	\$ 11.79
PC68CBM-106G	10 MM	3/8"	\$ 2.47	5	\$ 12.33
PC68CBM-108G	10 MM	1/2"	\$ 3.83	5	\$ 19.13

**MALE CONNECTOR  
MM X BSPT**



Part #	Push-In	BSPT	List Price	QTY	Pkg Price
PC68CBM-42R	4 MM	1/8"	\$ 0.94	5	\$ 4.68
PC68CBM-44R	4 MM	1/4"	\$ 1.47	5	\$ 7.35
PC68CBM-62R	6 MM	1/8"	\$ 1.10	5	\$ 5.52
PC68CBM-64R	6 MM	1/4"	\$ 1.54	5	\$ 7.72
PC68CBM-66R	6 MM	3/8"	\$ 1.99	5	\$ 9.97
PC68CBM-68R	6 MM	1/2"	\$ 3.35	5	\$ 16.77
PC68CBM-82R	8 MM	1/8"	\$ 1.42	5	\$ 7.09
PC68CBM-84R	8 MM	1/4"	\$ 1.47	5	\$ 7.35
PC68CBM-86R	8 MM	3/8"	\$ 1.94	5	\$ 9.71
PC68CBM-88R	8 MM	1/2"	\$ 3.62	5	\$ 18.08
PC68CBM-102R	10 MM	1/8"	\$ 2.04	5	\$ 10.22
PC68CBM-104R	10 MM	1/4"	\$ 2.05	5	\$ 10.27
PC68CBM-106R	10 MM	3/8"	\$ 2.05	5	\$ 10.27
PC68CBM-108R	10 MM	1/2"	\$ 3.35	5	\$ 16.77

**METRIC MALE  
ELBOW SWIVEL**



Part #	Push-In	M Thread	List Price	QTY	Pkg Price
PC69SCBM-4M5	4 MM	M 5	\$ 1.10	5	\$ 5.50
PC69SCBM-4M6	4 MM	M 6	\$ 1.10	5	\$ 5.50
PC69SCBM-6M5	6 MM	M 5	\$ 1.36	5	\$ 6.81
PC69SCBM-6M6	6 MM	M 6	\$ 1.36	5	\$ 6.81

**MALE ELBOW SWIVEL  
MM X BSPP**



Part #	Push-In	BSPP	List Price	QTY	Pkg Price
PC69SCBM-42G	4 MM	1/8"	\$ 1.42	5	\$ 7.09
PC69SCBM-44G	4 MM	1/4"	\$ 1.94	5	\$ 9.71
PC69SCBM-62G	6 MM	1/8"	\$ 1.54	5	\$ 7.72
PC69SCBM-64G	6 MM	1/4"	\$ 2.11	5	\$ 10.53
PC69SCBM-66G	6 MM	3/8"	\$ 2.78	5	\$ 13.89
PC69SCBM-68G	6 MM	1/2"	\$ 4.40	5	\$ 22.01
PC69SCBM-82G	8 MM	1/8"	\$ 2.20	5	\$ 11.02
PC69SCBM-84G	8 MM	1/4"	\$ 2.31	5	\$ 11.53
PC69SCBM-86G	8 MM	3/8"	\$ 2.93	5	\$ 14.67
PC69SCBM-88G	8 MM	1/2"	\$ 4.30	5	\$ 21.50
PC69SCBM-102G	10 MM	1/8"	\$ 3.16	5	\$ 15.79
PC69SCBM-104G	10 MM	1/4"	\$ 3.31	5	\$ 16.54
PC69SCBM-106G	10 MM	3/8"	\$ 3.31	5	\$ 16.54
PC69SCBM-108G	10 MM	1/2"	\$ 4.71	5	\$ 23.56

**MALE ELBOW SWIVEL  
MM X BSPT**



Part #	Push-In	BSPT	List Price	QTY	Pkg Price
PC69SCBM-42R	4 MM	1/8"	\$ 1.17	5	\$ 5.85
PC69SCBM-44R	4 MM	1/4"	\$ 1.68	5	\$ 8.40
PC69SCBM-62R	6 MM	1/8"	\$ 1.54	5	\$ 7.72
PC69SCBM-64R	6 MM	1/4"	\$ 1.75	5	\$ 8.77
PC69SCBM-66R	6 MM	3/8"	\$ 2.41	5	\$ 12.05
PC69SCBM-68R	6 MM	1/2"	\$ 3.67	5	\$ 18.34
PC69SCBM-82R	8 MM	1/8"	\$ 1.83	5	\$ 9.17
PC69SCBM-84R	8 MM	1/4"	\$ 1.86	5	\$ 9.29
PC69SCBM-86R	8 MM	3/8"	\$ 2.57	5	\$ 12.84
PC69SCBM-88R	8 MM	1/2"	\$ 3.56	5	\$ 17.82
PC69SCBM-102R	10 MM	1/8"	\$ 2.88	5	\$ 14.41
PC69SCBM-104R	10 MM	1/4"	\$ 2.86	5	\$ 14.29
PC69SCBM-106R	10 MM	3/8"	\$ 2.86	5	\$ 14.29
PC69SCBM-108R	10 MM	1/2"	\$ 4.14	5	\$ 20.70

**METRIC RUN  
TEE SWIVEL**



Part #	Push-In	M Thread	List Price	QTY	Pkg Price
PC71SCBM-4M5	4 MM	M 5	\$ 1.78	5	\$ 8.91





**METRIC BRANCH TEE SWIVEL**

Part #	Push-In	M Thread	List Price	QTY	Pkg Price
PC72SCBM-4M5	4 MM	M 5	\$ 1.78	5	\$ 8.91



**BRANCH TEE SWIVEL  
MM X BSPT**

Part #	Push-In	BSPT	List Price	QTY	Pkg Price
PC72SCBM-84R	8 MM	1/4"	\$ 2.48	5	\$ 12.40



**UNION BULKHEAD**

Part #	Push-In	List Price	QTY	Pkg Price
PC82CBM-44	4 MM	\$ 2.43	5	\$ 12.16
PC82CBM-66	6 MM	\$ 2.76	5	\$ 13.80
PC82CBM-88	8 MM	\$ 3.18	5	\$ 15.91
PC82CBM-1010	10 MM	\$ 4.72	5	\$ 23.58
PC82CBM-1212	12 MM	\$ 5.87	5	\$ 29.36



**STEM REDUCER**

Part #	Stem	Push-In	List Price	QTY	Pkg Price
PC97CBM-46	4 MM	6 MM	QUOTE	5	QUOTE
PC97CBM-64	6 MM	4 MM	\$ 1.40	5	\$ 7.02
PC97CBM-86	8 MM	6 MM	\$ 1.25	5	\$ 6.27
PC97CBM-106	10 MM	6 MM	\$ 1.38	5	\$ 6.92
PC97CBM-108	10 MM	8 MM	\$ 1.82	5	\$ 9.12



**INLINE FLOW CONTROL**

Part #	Push-In	List Price	QTY	Pkg Price
PCSC-4CBM	4 MM	\$ 5.61	5	\$ 28.05
PCSC-6CBM	6 MM	\$ 5.37	5	\$ 26.83
PCSC-8CBM	8 MM	\$ 6.71	5	\$ 33.54
PCSC-10CBM	10 MM	\$ 7.81	5	\$ 39.04
PCSC-12CBM	12 MM	\$ 9.24	5	\$ 46.20



*Servicing Your Pneumatic Needs For Over 40 Years*

# Features and Specifications for Composite Transition Push to Connect Fittings

The transition fittings will connect your inch tube to a metric thread. These fittings have a BSPT, BSPP and NPT threads. They can be used in a variety of applications such as industrial, robotics, machinery, mobile and instrumentation.

Polyconn's CB composite fittings use a stainless-steel gripping-ring to grip nylon, 95 durometer polyurethane and polyethylene tubing. The nickel plated brass components on the fittings help to provide corrosion resistance and assist in prolonging the life of the fitting. All of the tapered threads come with pre-applied thread sealant and our parallel threads come with a recessed captive o-ring.

The advanced design of the Polyconn push-to-connect fitting places more gripper teeth in the fitting that are independent of the collet. This superior method allows the collet to guide and center the tubing into the fitting teeth on connection. When the need arises to disconnect, simply depress the collet which slides down and pushes the teeth entirely out of the way, disengaging the tubing completely.

## SPECIFICATIONS

TEMPERATURE RANGE	PRESSURE RANGE	VACUUM RATING
32°F - 140°F (0°C - 60°C)	0 - 150 PSI	TO -29.5" Hg

## FEATURES

- Collet detents fully retracting gripper teeth.
- An oval collet makes it easier to disengage tubing.
- Custom colored collets available upon request.
- Body material nickel plated brass and black PBT (Polybutylene).
- Locking ring stainless steel.
- O-Ring NBR
- Working pressure 150 PSI.
- Pre-applied thread sealant.

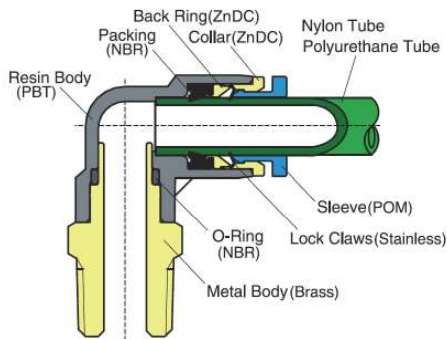

## USES

- Industrial
- Robotics
- Machinery
- Mobile
- Instrumentation

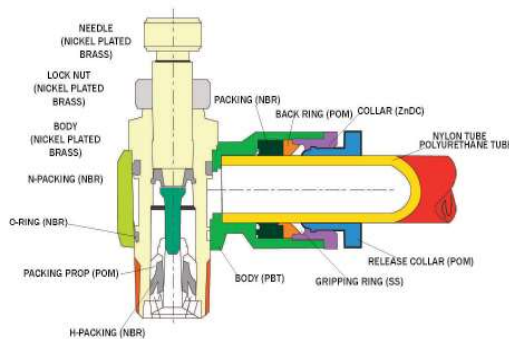

**MALE CONNECTOR  
MM X NPT**



Part #	Push-In	NPT	List Price	QTY	Pkg Price
PC68CBT-42	4 MM	1/8"	\$ 1.05	5	\$ 5.26
PC68CBT-44	4 MM	1/4"	\$ 1.59	5	\$ 7.95
PC68CBT-62	6 MM	1/8"	\$ 1.12	5	\$ 5.61
PC68CBT-64	6 MM	1/4"	\$ 1.10	5	\$ 5.52
PC68CBT-66	6 MM	3/8"	\$ 1.78	5	\$ 8.91
PC68CBT-82	8 MM	1/8"	\$ 1.20	5	\$ 6.01
PC68CBT-84	8 MM	1/4"	\$ 1.40	5	\$ 7.02
PC68CBT-86	8 MM	3/8"	\$ 1.75	5	\$ 8.77
PC68CBT-102	10 MM	1/8"	\$ 1.83	5	\$ 9.17
PC68CBT-104	10 MM	1/4"	\$ 1.81	5	\$ 9.03
PC68CBT-106	10 MM	3/8"	\$ 2.15	5	\$ 10.74

**MALE CONNECTOR  
INCH X BSPP**



Part #	Push-In	BSPP	List Price	QTY	Pkg Price
PC68CBT-12G	5/32"	1/8"	\$ 1.30	5	\$ 6.48
PC68CBT-14G	5/32"	1/4"	\$ 2.00	5	\$ 10.00
PC68CBT-42G	1/4"	1/8"	\$ 1.57	5	\$ 7.84
PC68CBT-44G	1/4"	1/4"	\$ 2.11	5	\$ 10.53
PC68CBT-46G	1/4"	3/8"	\$ 2.81	5	\$ 14.06
PC68CBT-64G	3/8"	1/4"	\$ 2.92	5	\$ 14.60
PC68CBT-66G	3/8"	3/8"	\$ 2.92	5	\$ 14.60
PC68CBT-86G	1/2"	3/8"	\$ 4.40	5	\$ 21.99

**MALE CONNECTOR  
INCH X BSPT**



Part #	Push-In	BSPT	List Price	QTY	Pkg Price
PC68CBT-22R	1/8"	1/8"	\$ 1.14	5	\$ 5.68
PC68CBT-24R	1/8"	1/4"	\$ 1.19	5	\$ 5.94
PC68CBT-42R	1/4"	1/8"	\$ 1.22	5	\$ 6.08
PC68CBT-44R	1/4"	1/4"	\$ 1.64	5	\$ 8.19
PC68CBT-46R	1/4"	3/8"	\$ 2.38	5	\$ 11.88
PC68CBT-62R	3/8"	1/8"	\$ 2.33	5	\$ 11.63
PC68CBT-64R	3/8"	1/4"	\$ 2.67	5	\$ 13.33
PC68CBT-66R	3/8"	3/8"	\$ 2.54	5	\$ 12.70

**MALE ELBOW SWIVEL  
MM X NPT**



Part #	Push-In	NPT	List Price	QTY	Pkg Price
PC69SCBT-42	4 MM	1/8"	\$ 1.40	5	\$ 7.02
PC69SCBT-44	4 MM	1/4"	\$ 1.45	5	\$ 7.25
PC69SCBT-62	6 MM	1/8"	\$ 1.45	5	\$ 7.25
PC69SCBT-64	6 MM	1/4"	\$ 1.73	5	\$ 8.66
PC69SCBT-66	6 MM	3/8"	\$ 1.89	5	\$ 9.43
PC69SCBT-82	8 MM	1/8"	\$ 1.75	5	\$ 8.77
PC69SCBT-84	8 MM	1/4"	\$ 1.82	5	\$ 9.12
PC69SCBT-86	8 MM	3/8"	\$ 2.15	5	\$ 10.74
PC69SCBT-102	10 MM	1/8"	\$ 2.04	5	\$ 10.22
PC69SCBT-104	10 MM	1/4"	\$ 1.96	5	\$ 9.78
PC69SCBT-106	10 MM	3/8"	\$ 2.10	5	\$ 10.48

**MALE ELBOW SWIVEL  
MM X BSPP**



Part #	Push-In	BSPP	List Price	QTY	Pkg Price
PC69SCBT-12G	5/32"	1/8"	\$ 1.67	5	\$ 8.37
PC69SCBT-14G	5/32"	1/4"	\$ 2.33	5	\$ 11.63
PC69SCBT-42G	1/4"	1/8"	\$ 1.95	5	\$ 9.73
PC69SCBT-44G	1/4"	1/4"	\$ 2.65	5	\$ 13.24
PC69SCBT-46G	1/4"	3/8"	\$ 3.30	5	\$ 16.49
PC69SCBT-64G	3/8"	1/4"	\$ 4.11	5	\$ 20.54
PC69SCBT-66G	3/8"	3/8"	\$ 4.11	5	\$ 20.54
PC69SCBT-86G	1/2"	3/8"	\$ 5.73	5	\$ 28.63

**MALE ELBOW SWIVEL  
MM X BSPT**



Part #	Push-In	BSPT	List Price	QTY	Pkg Price
PC69SCBT-22R	1/8"	1/8"	\$ 1.46	5	\$ 7.30
PC69SCBT-24R	1/8"	1/4"	\$ 2.00	5	\$ 10.00
PC69SCBT-42R	1/4"	1/8"	\$ 1.67	5	\$ 8.37
PC69SCBT-46R	1/4"	3/8"	\$ 2.86	5	\$ 14.32
PC69SCBT-62R	3/8"	1/8"	\$ 3.46	5	\$ 17.29
PC69SCBT-64R	3/8"	1/4"	\$ 3.56	5	\$ 17.82
PC69SCBT-66R	3/8"	3/8"	\$ 3.56	5	\$ 17.82

**FEMALE BULKHEAD  
MM X NPT**



Part #	Push-In	NPT	List Price	QTY	Pkg Price
PC86CBT-104	10 MM	1/4"	\$ 3.07	5	\$ 15.35

See our full line of inch and metric tubing on our web site.  
[www.polyonn.com](http://www.polyonn.com)

Polyconn offers Push-In fittings in many different materials!



Tubing:  
Polyconn carries  
Polyurethane, Nylon,  
Polyethylene and many  
more materials to choose  
from!

Push to Connect Fittings:  
Composite  
NSF Acetal Plastic  
Nickel Plated Brass  
Stainless Steel  
D.O.T. Brass  
D.O.T Composite

**Polyconn®** the one-stop shop for your  
pneumatic needs.